

Program

78th

Annual Meeting

Southern Weed Science Society



Theme:

“Celebrating our history, while preparing for the future”

**January 20-23, 2025
Charleston Marriott
Charleston, SC**

PLEASE SUBMIT ABSTRACTS TO WEBSITE PRIOR TO MEETING

PLEASE SUBMIT POWERPOINT FILES TO WEBSITE

Local Arrangements Committee

Matt Cutulle	Chair
Eric Gustafson	Registration
Matt Cutulle	Audio Visual
Eric Gustafson	Equipment Storage & Security
Eric Gustafson	Graduate Students & Room Reservations
Eric Gustafson	Information Booth & Message Coordinator
Matt Cutulle and Mike Marshall	Meal Functions
Matt Cutulle and Mike Marshall	Room Setup
Matt Cutulle and Mike Marshall	Signs and Exhibits
Matt Cutulle and Mike Marshall	Poster Setup

Special Events

Endowment Function/Graduate Student Mixer & Social

Sunday, January 19, 2025

6:00 p.m. – 9:00 p.m.

SWSS General Session

Monday, January 20, 2025

1:00 p.m. – 5:00 pm

Graduate Student Luncheon

Tuesday, January 21, 2025

12:30 p.m. – 2:00 p.m.

Women's Networking Event

Tuesday, January 21, 2025

3:00 p.m. – 5:00 p.m.

Graduate Student Quiz Bowl

Tuesday, January 21, 2025

5:30 p.m. – 7:30 p.m.

Christian Fellowship Breakfast

Wednesday, January 22, 2025

6:30 a.m. – 7:45 a.m.

SWSS Awards Luncheon

Wednesday, January 22, 2025

12:00 p.m. – 2:00 p.m.

Graduate Student Awards Reception and Mixer

Wednesday, January 22, 2025

6:00 p.m. – 8:00 p.m.

Future Meetings

Sheraton Music City

Nashville, TN – January 26 - 29, 2026

Southern Weed Science Society Officers

PRESIDENT

Todd Baughman
Texas A&M
Todd.baughman@ag.tamu.edu
(940) 613-1275

PRESIDENT ELECT

Eric Palmer
Syngenta
eric.palmer@syngenta.com
(662) 822-1584

VICE PRESIDENT

Shawn Askew
Virginia Tech
saskew@vt.edu
(540) 231-5807

PAST PRESIDENT

Eric Castner
FMC
eric.castner@fmc.com
(817) 597-1852

SECRETARY- TREASURER

Hunter Perry
Corteva Agriscience
hunter.perry@corteva.com
(662) 686-9654

EDITOR

Paul Tseng
Mississippi State University
tt1024@msstate.edu
(662) 325-4725

MEMBERS-AT-LARGE (ACADEMIA)

Charlie Cahoon
N.C. State University
cwcahoon@ncsu.edu
(252) 904-1242

David Russell
Auburn University
dpr0013@auburn.edu
(601) 757-5663

MEMBERS-AT-LARGE (INDUSTRY)

Adam Hixon
BASF
adam.hixson@basf.com
(806) 441-6025

Matthew Wiggins
FMC
matthew.wiggins@fmc.com
(731) 617-0840

WSSA REPRESENTATIVE

Pete Dotray
Texas Tech University
pdotray@ag.tamu.edu
(806) 834-3685

BUSINESS MANAGER (EX-OFFICIO)

Eric Gustafson
IMI Group
eric@imigroup.org
(303) 433-4446

CONSTITUTION AND OPERATING PROC (EX-OFFICIO)

Carroll Johnson
Whitetail Institute
carroll@whitetailinstitute.com
(229) 402-1503

STUDENT REPRESENTATIVE (EX-OFFICIO)

Navdeep Godara
Virginia Tech
ngodara@vt.edu

Southern Weed Science Society

Committees and Chairpersons

2025 Program	Eric Palmer
2026 Program	Shawn Askew
Awards	Eric Castner
Business Manager/Sales Coordination	Eric Gustafson
Computer Application	Sarah Kezar
Constitution & Operating Procedures	Carroll Johnson
Education Units	Bruce Kirksey
Endowment Foundation	Jason Bond
Finance	Shawn Askew
Graduate Student Organization	Navdeep Godara
Legislative and Regulatory	Shawn Askew
Local Arrangements	Matt Cutulle
Long Range Planning	Darrin Dodds
Newsletter Editor	Justin Calhoun
Nominating	Eric Castner
Resolutions and Necrology	Joey Williams
Site Selection	Ben McKnight
Southern Weed Contest	Hannah Wright-Smith
Student Program	Hannah Wright-Smith
Sustaining Membership	Kelly Backscheider
Weed Resistance and Technology Stewardship	Michael Flessner

Program Section Chairs

Agronomic Crops	Pete Eure
Weed Management in Turf	Amy Wilbur
Weed Management in Pastures & Rangeland	Kayla Broster
Weed Management in Horticultural Crops	Greg Steele
Forest Vegetation Management	David Clabo
Vegetation Management in Utilities, Railroads, & Highway Rights-of-Way; Industrial Sites	Chris Gregory
Physiological and Biological Aspects of Weed Control	Luis Avila
Educational Aspects of Weed Control	Nick Basinger
Regulatory Aspects of Weed Control	Stanley Culpepper
Invasive Species	John Byrd
New Technologies	Lauren Lazaro
Soil and Environmental Aspects of Weed Science	Kayla Eason
Posters	Zach Treadway
Graduate Student Contest	Hannah Wright-Smith

Registration

MONDAY, January 20, 2025

8:00 a.m. – 5:00 p.m.

TUESDAY, January 21, 2025

8:00 a.m. – 5:00 p.m.

WEDNESDAY, January 22, 2025

8:00 a.m. – 3:00 p.m.

Displays and Posters

Set-up time for displays and the Poster Session is 10:00 am to noon on Monday, January 20, 2025 in Crystal A&B. The poster area will be open from 3:00 pm to 5:00 pm on Monday, 7:00 am to 5:00 pm on Tuesday, and 7:00 am to 4:00 pm on Wednesday.

Contest poster authors do not have to be present for judging.

Displays and Posters must be removed before 4:00 pm on Wednesday, January 22, 2025

Silent Auction

Silent Auction will take place in Pre-Function Area and will close on **Wednesday, January 22, 2025 at 1:00 pm**

Auction item pick up will immediately follow and close at approximately 4:00 pm

Location of Events

SWSS Executive Board Meetings	Opal One
Local Arrangements	Coat Room
Graduate Contest Judge's Breakfast	Opal One
Graduate Contest Judge's Work Room	Yellow Topaz
General Session	Crystal C&D
SWSS Business Meeting	Crystal C&D
SWSS Quiz Bowl	Emerald Ballroom
GSO Luncheon	Emerald Salon One
Christian Fellowship Breakfast	Crystal E
Women's Networking Mixer	Crystal E
SWSS Awards Luncheon	Emerald Salon Two & Three
SWSS Student Award Reception	Emerald Ballroom

PROGRAM OVERVIEW

Schedule of Events and Meetings

SUNDAY, January 19, 2025

8:00 am – 5:00 pm	Local Arrangements <i>Coat Room</i>
3:30 pm – 5:30 pm	SWSS Executive Board Meeting <i>Opal One</i>
6:00 pm – 9:00 pm	Endowment Function/Graduate Student Mixer & Social <i>Top Golf</i>

MONDAY, January 20, 2025

7:00 am – 5:00 pm	Local Arrangements <i>Coat Room</i>
7:00am – 8:00 am	Program Committee <i>Opal Two</i>
8:00 am – 5:00 pm	Registration/Presentation Loading <i>Crystal Lobby</i>
8:00 am – 9:00 am	Legislative & Regulatory Comm. <i>Opal Two</i>
8:00 am – 9:00 am	Weed Resistance Resistant and Technology Stewardship Comm. <i>Opal One</i>
8:00 am – 9:00 am	Endowment Foundation Committee <i>Crystal E</i>
9:00 am – 10:00 am	Site Selection Committee <i>Crystal E</i>
9:00 am – 10:00 am	Weed Contest Committee <i>Crystal F</i>
9:00 am – 10:00 am	Finance Committee <i>Opal Two</i>
10:00 am – 11:00 am	Long Range Planning Committee <i>Crystal E</i>
11:00 am – Noon	SWSS Executive Board Meeting <i>Opal One</i>
1:00 pm – 5:00 pm	General Session <i>Crystal C&D</i>
5:00 pm – 6:00 pm	SWSS Business Meeting <i>Crystal C&D</i>
Immediately after Business Meeting	Weed Contest Committee <i>Crystal C&D</i>

TUESDAY, January 21, 2025

6:00 am – 7:15 am	Graduate Student Contest Judges Breakfast <i>Opal One</i>
7:00 am – 7:00 pm	Local Arrangements <i>Coat Room</i>
8:00 am – 5:00 pm	Graduate Student Contest Judges Work Room <i>Yellow Topaz</i>
8:00 am – 5:00 pm	Registration/Presentation Loading <i>Crystal Lobby</i>
12:30pm – 2:00 pm	Graduate Student Luncheon <i>Emerald Salon One</i> Sponsored by: BASF, Bayer CropScience, FMC, and Syngenta Crop Protection
3:00 pm – 5:00 pm	Women’s Networking Event <i>Crystal E</i> Sponsored by: Corteva AgriScience
5:30 pm – 7:30 pm	Graduate Student Quiz Bowl <i>Emerald Ballroom</i> Sponsored by: Bayer CropScience and Syngenta Crop Protection

WEDNESDAY, January 22, 2025

6:30 am – 7:45 am	Christian Fellowship Breakfast <i>Crystal E</i>
7:00 am – 5:00 pm	Local Arrangements <i>Coat Room</i>
8:00 am – 5:00 pm	Registration/Presentation Loading <i>Crystal Lobby</i>
Noon – 2:00 pm	SWSS Awards Luncheon <i>Emerald Salon Two & Three</i>
6:00 pm – 6:30 pm	SWSS Mixer <i>Emerald Ballroom</i>
6:30 pm – 8:00 pm	SWSS Graduate Student Awards Reception <i>Emerald Ballroom</i>

THURSDAY, January 23, 2025

8:00 am – 10:00 am	SWSS Executive Board Breakfast & Board Meeting <i>Opal One</i>
8:00 am – 9:00 am	Local Arrangements Committee <i>Coat Room</i>

TECHNICAL PROGRAM OVERVIEW

MONDAY, January 20, 2025

10:00 am – Noon	Poster Setup <i>Crystal A&B</i>
1:00 pm – 5:00 pm	General Session <i>Crystal C&D</i>
3:00 pm – 5:00 pm	Posters - Available for Viewing <i>Crystal A&B</i>

TUESDAY, January 21, 2025

7:00 am – 5:00 pm	Posters Session <i>Crystal A&B</i>
7:30 am – 12:15 pm	Student Paper Contest <i>Crystal C</i>
7:30 am – 12:15 am	Student Paper Contest <i>Crystal D</i>
7:30 am – 12:15 pm	Student Paper Contest <i>Crystal F</i>

***All paper and poster judges please have completed score sheets to Hannah Wright-Smith by 5:00 pm on Tuesday**

2:00 pm – 2:30 pm	Forest Vegetation Management <i>Opal Two</i>
2:00 pm – 2:45 pm	Weed Management in Pastures & Rangeland <i>Opal One</i>
2:30 pm – 4:45 pm	New Technologies <i>Crystal D</i>
3:00 pm – 3:45 pm	Soil and Environmental Aspects of Weed Control <i>Opal Two</i>
4:00 pm – 4:15 pm	Educational Aspects of Weed Control <i>Opal Two</i>
4:00 pm – 5:00 pm	Weed Management in Agronomic Crops <i>Crystal D</i>

WEDNESDAY, January 22, 2025

7:00 am – 4:00 pm	Posters Session <i>Crystal A&B</i>
-------------------	---

***Posters removed before 4:00 p.m.**

WEDNESDAY, January 22, 2025

- 8:00 am – 4:30 pm Weed Management in Agronomic Crops
Crystal C
- 9:00 am – 11:15 am Weed Management in Turf
Crystal D
- 10:30 am – 11:30 am Physiological and Biological Aspects of Weed Control
Crystal F
- 2:30 pm – 3:30 pm Weed Management in Horticultural Crops
Crystal D

THURSDAY, January 23, 2025

- 8:00 am – 10:00 am SWSS Executive Board Breakfast & Meeting
Opal One
- 8:00 am – 9:00 am Local Arrangements
Coat Room

Notes: _____

PROGRAM

Poster Section

LOCATION: Crystal A&B
CHAIR & MODERATOR: Zach Treadway
University of AR
Fayetteville, AR

*PRESENTER † STUDENT CONTEST

† **When Spray Drones Meet the Wind: Drift Control Through Nozzle model, Speed, and flight height**

Antonio Augusto Tavares*¹, Lucas Rector¹, Sydney Baker Holley¹, Luis de Avila¹, Darrin Dodds¹;
(1)Mississippi State University, Starkville, MS (1)

† **Determining drift potential of Unmanned Aerial System using machine learning approach.**

Fatemeh Esmailbeiki*¹, Daniel E Martin², Vijay Singh¹; (1) Virginia Tech, Painter, VA, (2)USDA, College Station, TX (2)

† **Assessing Herbicide Injury in Cotton Using UAV-based Thermal and Multispectral Imagery**

Bismark Anokye*¹; (1)Texas A&M University, College Station, TX (3)

† **Weed Population Changes Over Three Years with Single-Tank See & Spray™ Programs in Soybean**

Tristen Avent*¹, Jason Norsworthy¹, Michael Dodde¹, Lane Pierce², Luaren Lazaro³; (1)University of Arkansas, Fayetteville, AR; (2)University of Arkansas, Santa Clara, CA, (3)Blue River Technology, Santa Clara, CA (4)

† **Targeting Weed Seeds in Cotton Cropping Systems**

Sarah Chu*¹, Eli Russell², Gaylon Morgan³, Michael Walsh⁴, Benjamin McKnight¹, Robert Hardin¹, Peter Dotray⁵, Michael Flessner², Muthukumar Bagavathiannan¹;
(1)Texas A&M University, College Station, TX, (2)Virginia Tech, Blacksburg, VA, (3)Cotton Incorporated, Cary, NC, (4)Charles Sturt University, Bathurst, AU, (5)Texas Tech University, Lubbock, TX (5)

† **Management of Italian Ryegrass (*Lolium perenne* ssp. *multiflorum*) Using a Seed Control Unit at Winter Wheat Harvest in Kentucky**

Hayden Love*¹, Travis Legleiter²; (1)University of Tennessee, Knoxville, TN, (2)University of Kentucky, Princeton, KY (6)

† **Comparing Velpar to Glyphosate+Rezilon for Smutgrass (*Sporobolus indicus* L.) Control**

Kayla Broster*¹, John Byrd¹, Chris Gregory¹, Thomas Duncan¹;
(1)Mississippi State University, Starkville, MS (7)

† **Drought Stress Does Not Alter the Allelopathic Potential of *Cosmos sulphureus***

Bruna Dal'Pizol Novello*¹, Leticia Leite², Te Ming Tseng³,
Pedro Luís da Costa Aguiar Alves²; (1)São Paulo State University,
Mississippi State University, Jaboticabal, (2)São Paulo State
University, Jaboticabal, (3)Mississippi State University, Starkville,
MS (8)

† **A Novel Approach to Estimating Weed Cover in Turfgrass Research Using Deep Learning**

Mikerly Mistral Joseph*¹, Katarzyna Gawron¹, Pawel Petelewicz¹;
(1)University of Florida, Gainesville, FL (9)

† **Simulated Foot Traffic Affects Athlete Biomechanics on Weedy Hybrid Bermudagrass Sports Fields**

Erick Begitschke*¹, Audrey Young¹, C. Julie Wang¹, Alberto Novello¹, Rob Lynall¹, Gerald Henry¹; (1)University of Georgia, Athens, GA (10)

† **Mid-infrared radiation-mediated thermal weed control is influenced by species and growth stage**

Ryan Hamberg*¹, Muthu Bagavathiannan¹; (1)Department of Soil and Crop Sciences, Texas A&M University, College Station, TX (11)

† **Impact of Cover Cropping and Tillage Practices on Weed Seed Bank Dynamics**

Mahmoud Rady*¹, Matthew Cutulle¹, Brian Ward¹; (1)Plant and Environmental Sciences Department, Coastal Research and Education Center, Clemson University, Charleston, SC (12)

† **Waterhemp Seedling Emergence Pattern is Influenced by Tillage and Cereal Rye Cover Across a Latitudinal Gradient**

Purushottam Gyawali*¹, Pavle Pavlovic¹, Dylan Kerr², Ahmadreza Mobli³, Rodrigo Werle³, Jason Norsworthy⁴, Martin Williams⁵, Muthukumar Bagavathiannan¹; (1)Department of Soil and Crop Sciences, Texas A&M University, College Station, TX, (2)Department of Crop Sciences, University of Illinois at Urbana-Champaign, Urbana, IL, (3)Department of Agronomy, University of Wisconsin–Madison, Madison, WI, (4)Department of Crop, Soil, and Environmental Sciences, University of Arkansas, Fayetteville, AR, (5)Global Change and Photosynthesis Research Unit, USDA-ARS, Urbana, IL (13)

† **Alternative Burndown Programs in Rice for Reduced Plant-back Restrictions**

Eve Williams*¹, Connor Webster¹, Maranda Hains¹, Gavin Sparks¹, Wesley Carr¹, Ben Stoker¹; (1)LSU AgCenter, Baton Rouge, LA (14)

† **Control of Palmer amaranth and velvetleaf with trinexapac and herbicide mixtures**

Keith Andzrej Monsalud*¹, Juan Camilo Velasquez Rodriguez¹, Prakriti Dhaka¹, Diego Rodriguez¹, Giovana de Carvalho Silva¹, Jianping Zhang¹, Nilda Roma Burgos¹; (1)University of Arkansas, Fayetteville, AR (15)

† **Rindé™ use in Rice Weed Control Programs Targeting Baryardgrass**

James Malone*¹, Jason Norsworthy¹, L Barber¹; (1)University of Arkansas System Division of Agriculture, Fayetteville, AR (16)

† **Preemergence Herbicide Strategies affecting Postemergence Targeted Herbicide Sprays**

Lane Pierce*¹, Jason Norsworthy¹, Tristen Avent¹, Michael Dodde¹; (1)University of Arkansas System Division of Agriculture, Fayetteville, AR (17)

† **Warrant Use in Roxy Rice Herbicide Programs with and without a Fenclorim Seed Treatment**

Rhet Baxley*¹, Jason Norsworthy¹, Tristen Avent¹, Michael Dodde¹, Cory Ketchum¹; (1)University of Arkansas System Division of Agriculture, Fayetteville, AR (18)

† **Dicamba Cotton Technology Provides Flexibility Georgia Growers Value**

Jenna Vance*¹, Taylor Randell-Singleton¹, Stanley Culpepper¹; (1)University of Georgia, Tifton, GA (19)

† **Cover Crop Termination Timing and Herbicide Interactions to Mitigate Herbicide-Resistant Palmer Amaranth Seedbank in the Southern U.S. Soybean Production**

Giulia Bortolon*¹, Prashant Jha¹, Daniel Stephenson², Matt Foster³, Bhupesh Dhaka¹, Fagner Rontani¹, Connor McKoin¹; (1)Louisiana State University AgCenter, Baton Rouge, LA, (2)Louisiana State University AgCenter, Dean Lee Research Station, Alexandria, LA, (3)Louisiana State University AgCenter, St. Gabriel, LA (20)

† **AI-Driven Real-Time Weed Detection and Precision Spot Spraying System.**

Rutvij Wamanse*¹, Dhiraj Shrivastava², Vijay Singh¹; (1)Virginia Tech Eastern Shore AREC, Painter, VA, (2)Donald Danforth Plant Science Center, Saint Louis, MO (21)

† **Determining Pre-Emergent Herbicide Options for North Carolina Pollinator Species**

Hunter Lee*¹; (1)North Carolina State University, Raleigh, NC (22)

† **Field Validation of Minimized-Rate Topramezone and Metribuzin Programs for Goosegrass Control in Florida**

Katarzyna Gawron*¹, Patrick McLoughlin², Mikerly M. Joseph¹, Sergio A. Gallo², Marco Schiavon², Pawel Petelewicz¹; (1)University of Florida, Gainesville, FL, (2)University of Florida, Davie, FL (23)

† **Turf and Weed Response to Organic Herbicides Applied by Machine Vision Sprayer**

Aman Jakhar*¹, Shawn Askew¹, Amy Wilber², JayMcCurdy², Suzannah Hale¹, Navdeep Godara¹, Juan Romero¹, Pierre Le Naour Vernet³; (1)Virginia Tech, Blacksburg, VA, (2)Mississippi State University, Starkville, MS, (3)Ecorobotix, Yverdon-les-Bains, CH (24)

† **From Lab to Field: Predicting Seed Longevity in Palmer Amaranth (*Amaranthus palmeri*) using Accelerated Aging Test**

Akashdeep Singh*¹, Aniruddha Maity¹, David Russell¹; (1)Auburn University, Auburn, AL (25)

† **Influence of Late-Season Herbicides on Survival, Fecundity and Progeny Fitness of Glyphosate-Resistant Italian Ryegrass.**

Bhupesh Dhaka*¹, Prashant Jha¹, Donnie Miller¹, Connor McKoin¹, Fagner Rontani¹, Giulia Bortolon¹; (1)Louisiana State University AgCenter, Baton Rouge, LA (26)

† **Multiple Herbicide Resistant Palmer amaranth in Virginia**

Milos Viric*¹, Vijay Singh¹, Michael Flessner²; (1)Virginia Tech, Painter, VA, (2)Virginia Tech, Blacksburg, VA (27)

† **Effect of Long-Term Cover Cropping, Irrigation, and Crop Rotation on Weed Population Dynamics: The Old Rotation Experiment (circa 1896)**

Gourav Chahal*¹, Carter Bonnell¹, Andrew Price², Audrey Gamble¹, Steve Li¹; (1)Auburn University, Auburn, AL, (2)USDA-ARS, Auburn, AL (28)

† **Common Turfgrass Weeds Affect Sports Field Performance and Athlete Biomechanics**

Audrey Young*¹, Erick Begitschke¹, Chih Julie Wang¹, Gerald Henry¹, Rob Lynall¹; (1)University of Georgia, Athens, GA (29)

Peanut Response to Postemergence Applications of Brake (fluridone)

Eric Prostko*¹, Nick Shay¹, Chad Abbott²; (1)University of Georgia, Tifton, GA, (2)SePRO, Tifton, GA (30)

The Benefits of Overlapping Residual Herbicides in Weed Management Programs for Multiple Herbicide-Resistant Amaranthus Populations in Corn

James Holloway*¹, Marshall Hay², Mark Kitt³, David Belles³, Tom Beckett³, Eric Palmer³, Jesse Haarmann⁴; (1)Syngenta Crop Protection, LLC, Jackson, TN, (2)Syngenta Crop Protection, LLC, Garden Plain, KS, (3)Syngenta Crop Protection, LLC, Greensboro, NC, (4)Syngenta Crop Protection, LLC, Rochester, MN (31)

How do Cover Crop Mixtures Influence Weed Diversity in Southern Crop Rotations?

Andrew Ahlersmeyer*¹, Audrey Gamble¹, Andrew Price², Aniruddha Maity¹; (1)Auburn University, Auburn, AL, (2)USDA-ARS, Auburn, AL (32)

Fluridone Application Timings in Louisiana Rice

Wesley Carr*¹, Connor Webster¹, Ben Stoker¹, Maranda Hains¹, Gavin Sparks¹; (1)LSU AgCenter, Baton Rouge, LA (33)

Effect of Low Rate of 2,4-D on Tomato at Different Growth Stages.

Taghi Bararpour*¹, Te Ming Tseng²; (1)Mississippi State University, Delta Research & Extension Center, Stoneville, MS, (2)Mississippi State University, Starkville, MS (34)

Annual Bluegrass Response to Liquid Nitrogen Applied via Individual-Plant-Treatment System.

Juan Romero*¹, Navdeep Godara¹, Suzannah Hale¹, Shawn Askew¹; (1)Virginia Tech, Blacksburg, VA (35)

Weed Management Programs in Mississippi Peanut.

Taghi Bararpour*¹, Brendan Zurweller²; (1)Mississippi State University, Stoneville, MS, (2)Mississippi State University, Starkville, MS (36)

Overview of Fimbristylis littoralis Identification and Control in Louisiana Rice

Gavin Sparks*¹, Connor Webster¹, Ben Stoker¹, Maranda Hains¹, Wesley Carr¹, Eve Williams¹; (1)LSU Ag Center, Baton Rouge, LA (37)

Influence of Adjuvants with Topramezone and Liberty ULTRA on Axant™ Flex Cotton Response

Matthew Woolard*¹, Peter Dotray², Adam Hixson³, Megan Singletary¹, Brad Guice⁴; (1)Texas Tech University, Lubbock, TX, (2)Texas Tech University, Texas A&M AgLife Research and Extension Service, Lubbock, TX, (3)BASF, Lubbock, TX, (4)BASF, Winnsboro, LA (38)

Glufosinate Sensitivity of Palmer Amaranth Accessions Collected in 2001 and 2023

Susee Sudhakar*¹, Jason Norsworthy¹, Pamela Carvalho-Moore¹, Jason Bond², Michael Marshall³, Larry Steckel⁴, Muthukumar Bagavathiannan⁵, Aimone Porri⁶, Ingo Meiners⁷; (1)University of Arkansas, Fayetteville, AR, (2)Mississippi State University, Stoneville, MS, (3)Clemson University, Blackville, SC, (4)University of Tennessee, Jackson, TN, (5)Texas A&M University, College Station, TX, (6)BASF SE, Limburgerhof, GER, (7)BASF, Research Triangle Park, NC (39)

Optimizing anaerobic soil disinfestation with biosolids and novel plasticulture for weed management

Priyanka Gupta*¹, Bhupinder Jatana², Matthew Cutulle³, Chandrasekar S Kousik⁴, Brian Ward³, Tom Grayson Sanders² Ashok Sah²; (1)Clemson University, Clemson, SC, (2)Edisto Research and Education Centre, Clemson University, Blackville, SC, (3)Coastal Research and Education Center, Clemson University, Charleston, SC, (4)USDA-ARS Clemson University, Charleston, SC (40)

Effect of Dicamba in Glyphosate Tank Mixtures on Grass Control Brock Dean*¹, Charles Cahoon¹, Zachary Taylor¹, Jose de Sanctis¹, Hunter Lee¹; (1)North Carolina State University, Raleigh, NC (41)

Exploring the role of pesticides in establishing habitat for sensitive species on agricultural lands

Taylor Randell-Singleton*¹, Nick McGhee², Richard Barrett²; (1)University of Georgia, Tifton, GA, (2)USDA - NRCS Jimmy Carter Plant Materials Center, Americus, GA (42)

Weed Management Programs in Mississippi Corn.

Taghi Bararpour*¹, Jason Bond¹, Corey Bryant¹; (1)Mississippi State University, Delta Research & Extension Center, Stoneville, MS (43)

Anaerobic Soil Disinfestation: A Catalyst for Weed Management in Organic Watermelon Production in South Carolina

Sohaib Chattha*¹, Brian Ward¹, Matthew Cutulle¹; (1)Clemson University, Coastal Research and Education Center, Charleston, SC (44)

Application Placement Effects on Efficacy of Endothall for Poa annua Control Logan Smith*¹, Jose Vargas¹, Jim Brosnan¹; (1)University of Tennessee, Knoxville, TN (45)

CO₂ and temperature influence Palmer amaranth populations' growth, development, 14C translocation, and epicuticular waxes composition. Juliana de Souza Rodrigues*¹, Donn Shilling², Nicholas Basinger, Timothy Grey¹; (1)University of Georgia, Tifton, GA, (2)University of Georgia, Athens, GA (46)

Lettuce tolerance to pendimethalin on organic soil

Walter Wong*¹, Calvin Odera¹; (1)University of Florida, Everglades Research & Education Center, Belle Glade, FL (47)

Memory Induced by Recurrent Water Stress in Chirca

(Acanthostyles buniifolius) Tamara Heck*¹, Luis Avila², Gustavo Maia Sousa³, Rubens Antonio Polito³, Andrisa Balbinot⁴, Marcus Vinicius Fipke³, Edinaldo Rabaioli Camargo³; (1)Federal University of Pelotas, Mississippi State University, Pelotas/RS, (2)Mississippi State University, Starkville, MS, (3)Federal University of Pelotas, Pelotas/RS, (4)Syngenta, Lucas do Rio Verde, BR (48)

Status Of Amaranthus spp. Resistance to S-Metolachlor

Nestor Cordero*¹, Luis Avila¹, Jose Saavedra Avila¹, Alessandro Ulrich¹, Grazielle Posser¹, Te Ming Tseng¹, Taghi Bararpour¹, Jason Bond¹; (1)Mississippi State University, Starkville, MS (49)

Enversa: A New Encapsulated Acetochlor for Use in

Cotton Luke Szoch*¹, Andrew Blythe², Zachary Taylor¹, Hunter Lee¹, Charles Cahoon¹; (1)North Carolina State University, Raleigh, NC, (2)Corteva Agriscience, Fuquay-Varina, NC (50)

Amicarbazone as an Alternative Photosystem II Inhibitor

Herbicide in Corn Cory Ketchum*¹, Jason Norsworthy¹, Ryan Henry², Michael Dodde¹, Jared Smith¹, Rhet Baxley¹, Tom Barber¹; (1)University of Arkansas System Division of Agriculture, Fayetteville, AR, (2)UPL Solutions, Fort Wayne, IN (51)

Effective Late-Season Dowweed Control in Bermudagrass

Turf Using Mesotrione and Simazine-Based Tank-Mixes Pawel Petelewicz*¹, Katarzyna Gawron¹, Jayson Ging², Chase McKeithen², P. Agustin Boeri³, J. Bryan Unruh²; (1)University of Florida, Gainesville, FL (2)University of Florida, West Florida Research and Education Center, Jay, FL, (3)Texas A&M University, Dallas, TX (52)

Purple Nutsedge Growth Regulation in Response to

Postemergence Herbicides Alberto Novello*¹, Kevin Tucker¹, Gerald Henry¹; (1)University of Georgia, Athens, GA (53)

Confirmation of multiple resistance in goosegrass

(Eleusine indica) in North Carolina. Ronel Argueta*¹, Diego Contreras¹, Colden Bradshaw¹, Jackson Alsdorf¹, Charles Cahoon¹, Wesley Everman¹; (1)North Carolina State University, Raleigh, NC (54)

Weedy rice resistance to imidazolinone herbicides and

control with glyphosate in Colombia. Juan Velasquez*¹, Verónica Hoyos², Nilda Roma-Burgos¹, Guido Plaza¹; (1)University of Arkansas, Fayetteville, AR, (2)Universidad Nacional de Colombia, Cali (55)

Annual Bluegrass Control in Bermudagrass, Paspalum, and Zoysiagrass Golf Greens with Methiozolin

Patrick McCullough*¹; (1)McCullough Research and Development, Griffin, GA (56)

Evaluation of Season-Long Goosegrass Control Programs in Bermudagrass with Alternatives to Oxadiazon

Patrick McCullough*¹; (1)McCullough Research and Development, Griffin, GA (57)

Varietal Responses to Imazethapyr Carryover in Medium and Long Grain Rice (*Oryza sativa* L.)

Ben Stoker*¹, Connor Webster¹, Maranda Hains¹, Gavin Sparks¹, Wesley Carr¹, Eve Williams¹; (1)LSU AgCenter, Baton Rouge, LA (58)

Evaluating Interactions of Tetflupyrolimet Mixed with Other Preemergence Herbicides

Maranda Hains*¹, Connor Webster¹, Wesley Carr¹, Ben Stoker¹, Gavin Sparks¹, Eve Williams¹; (1)Louisiana State University, Baton Rouge, LA (59)

Differentiation of Male and Female Plants of Palmer amaranth (*Amaranthus palmeri*) using an RGB Sensor and Machine Learning Models: Detection and Classification

Bismark Anokye*¹; (1)Texas A&M University, College Station, TX (60)

Evaluating Herbicide Efficacy and Tolerance in Edamame (*Glycine max* (L.))

Akashdeep Singh Brar*¹, Michael Flessner², Bo Zhang², Mark Reiter¹, Vijay Singh¹; (1)Eastern Shore Agricultural Research and Extension Center, Virginia Tech, Painter, VA, (2)School of Plant and Environmental Sciences, Virginia Tech, Blacksburg, VA (61)

Biochar Herbicide Protection Pods for Mitigating Herbicide Sensitivity in Tomato Plants.

Fernanda Reolon de Souza*¹; (1)Mississippi State University, Starkville, MS (62)

Response of Yellow (*Cyperus esculentus* L.) and Purple (*Cyperus rotundus* L.) Nutsedge Growth Stage to Post Emergence Herbicides

Vijay Varanasi*¹, Taghi Bararpour², Partson Mubvumba¹, Reginald Fletcher¹, Krishna Reddy¹; (1)USDA-ARS-Crop Production Systems Research Unit, Stoneville, MS (2)Mississippi State University, Stoneville, MS (63)

Lettuce tolerance to pendimethalin on organic soil

Walter Wong*¹, Calvin Otero¹; (1)University of Florida, Everglades Research & Education Center, Belle Glade, FL (64)

Effect of poultry litter on the weed control efficiency of two pre-emergent herbicides (S-metolachlor and metribuzin) in diverse soil textures of Alabama Rakesh Ghosh*¹, Aniruddha Maity¹, Andrew Price²; (1)Auburn University, Auburn, AL , (2)USDA-ARS National Soil Dynamics Laboratory, Auburn, AL (65)

Integrating Herbicide Treatments and Prescribed Burning for Yellow Foxtail (*Setaria pumila*) Suppression in Bermudagrass Hayfield Tunde Akanbi*¹, Forrest Davis¹, Debra Smitherman¹, David Russell¹; (1)Auburn University, Auburn, AL (66)

Real-Time Weed Species Detection and Classification Ayman Almashwali*¹, Te Ming Tseng, Anuar Kassim²; (1)Mississippi State University, Universiti Teknikal Malaysia Melaka, Starkville, MS, (2)Universiti Teknikal Malaysia Melaka, Malacca (67)

Allelopathic Effects of Cover Crops on Yellow Nutsedge (*Cyperus esculentus*) Suppression: A Stair-Step Assay Alaina Richardson*¹, Ncomiwe Maphalala¹, Alyssa Miller¹, Worlayno Segbefia¹, Te ming Tseng¹; (1)Mississippi State University, Starkville, MS (68)

Herbicide Programs with Sequential Treatments of Tetflupyrolimet in Flooded Rice Lindsey Bell*¹, Jason Bond¹, Gregory Mangialardi¹, Dalton Whitt¹, Thomas Eubank¹, Jacob Dodd¹, Matt Edwards¹; (1)Mississippi State University, Starkville, MS (69)

Evaluation of Sulfentrazone Safety in Bell and Banna Pepper Tyler Campbell*¹, Matthew Cutulle¹; (1)Clemson University, Charleston, SC (70)

Field Assessment of Herbicide Tolerance in the Beauregard Sweetpotato (*Ipomoea batatas*) to Various Herbicidal Chemistries Alyssa Miller*¹, Te Ming Tseng¹, Lorin Harvey¹, Alaina Richardson¹, Josiane Argenta¹, Ncomiwe Maphalala¹; (1)Mississippi State University, Mississippi State, MS (71)

Mitigating Herbicide Injury in Soybean Growth and Nodulation: The Role of Biochar as a Soil Amendment Nestor Cordero*¹, Alessandro Ulrich¹, Luis Avila¹, Anderson Barbosa Evaristo², Jose Barbosa dos Santos³, Grazielle Posser¹, Eduardo Cassanego¹, Francisca Daniele De La Silva¹; (1) Mississippi State University, Starkville, MS, (2)Federal University of Jequitinhonha and Mucuri Valleys, City Unai, MG, Brazil, Unai, MG, Brazil, (3)Federal University of Jequitinhonha and Mucuri Valleys, Diamantina, MG, Brazil (72)

Newly Sprigged Hybrid Bermudagrass Tolerance to Postemergence Herbicides Navdeep Godara*¹, Daewon Koo¹, Hannah Wright-Smith², Shawn Askew¹; (1)Virginia Tech, Blacksburg, VA, (2)University of Arkansas, Little Rock, AR (73)

Chemical Options to Manage Glufosinate-Resistant Palmer amaranth Pamela Carvalho-Moore*¹, Jason Norsworthy¹, Tom Barber², Ingo Meiners³; (1)University of Arkansas System Division of Agriculture, Fayetteville, AR, (2)University of Arkansas System Division of Agriculture, Lonoke, AR, (3)BASF, Research Triangle Park, NC (74)

Application Timing and Its Role in Corn Tolerance to an Amicarbazone-Metribuzin Premixture Michael Dodde*¹, Jason Norsworthy¹, Pamela Carvalho-Moore¹, Maria Carolina Souza¹, Rhet Baxley¹; (1)University of Arkansas System Division of Agriculture, Fayetteville, AR (75)

Differential germination and seedling growth response of weed species to allelochemical toxicity in vitro Aliyah Warris*¹, James Holland², Virginia Moore³, Chris Reberg-Horton⁴, Steven Mirsky⁵, Ramon Leon¹; (1)North Carolina State University, Raleigh, NC, (2)North Carolina State University, U.S. Department of Agriculture, Agricultural Research Service, Raleigh, NC, (3)Cornell University, Ithaca, NY, (4)North Carolina State University, Ithaca, NY, (5)U.S. Department of Agriculture, Agricultural Research Service, Beltsville, MD (76)

Determination of Crop Safety of Herbicide Programs or Brassica carinata A. Braun Production Avi Goldsmith*¹, Edmilson Almeida², April Dobbs¹, Ramon Leon¹; (1)North Carolina State University, Raleigh, NC, (2)The Federal University of Maranhão, São Luís (77)

Double-crop soybean response to simulated carryover from HPPD herbicides Nicholas Shay*¹, Eric Prostko¹; (1)University of Georgia, Tifton, GA (78)

National Weed Survey: Problematic Weeds in Aquatic and Non-Crop Areas Sarah Chu*¹, Joshua Miranda², Lee Van Wychen³; (1)Texas A&M University, College Station, TX, (2)Oregon State University, Corvallis, OR, (3)Weed Science Society of America, Westminster, CO (79)

Does Adjuvant Selection Impact the Risk of Quizalofop Injuring TamArk™ and DoubleTeam™ Grain Sorghum? Wesley Herrman*¹, Jason Norsworthy¹, L Barber², Tristen Avent¹, Pamela Carvalho-Moore¹; (1)University of Arkansas System Division of Agriculture, Fayetteville, AR, (2)University of Arkansas System Division of Agriculture, Newport, AR (80)

Effect of Chaff Moisture on Italian Ryegrass (*Lolium perenne* ssp. *multiflorum*) Seed Kill with Impact Mills. Eli Russell*¹, Michael Flessner¹; (1)Virginia Tech, Blacksburg, VA (81)

Wheat-Soybean Relay Intercropping: System Yield and Palmer Amaranth Suppression Amar Godar*¹, Jason Norsworthy¹; (1)University of Arkansas, Fayetteville, AR (82)

Occurrence and Characterization of Newly Evolved Herbicide-Resistant Grass Weeds in Louisiana Cropping Systems Prashant Jha*¹, Giulia Bortolon¹, Bhupesh Dhaka¹, Fagner Rontani², Matt Foster³, Connor Webster¹, Donnie Miller¹, Daniel Stephenson⁴, Jason Norsworthy⁵; (1)Louisiana State University AgCenter, Baton Rouge, LA, (2)Louisiana State University, Baton Rouge, LA, (3)Louisiana State University AgCenter, St. Gabriel, LA, (4)Louisiana State University AgCenter, Alexandria, LA, (5)University of Arkansas, Fayetteville, AR (83)

Biochar Herbicide Protection Pods for Mitigating Herbicide Sensitivity in Tomato Plants. Fernanda Souza*¹, Sandipan Sil¹, Te Ming Tseng¹; (1)Mississippi State University, Mississippi State, MS (84)

Impact of Reduced Rates of Voraxor on Corn Growth and Yield Donnie Miller*¹, Prashant Jha², Ashley Barfield¹, Fagner Rontani², Bhupesh Dhaka², Giulia Bortolon², Connor McKoin²; (1)LSU AgCenter, St. Joseph, LA, (2)LSU AgCenter, Baton Rouge, LA (85)

Impact of Reduced Rates of Voraxor on Soybean Growth and Yield Donnie Miller*¹, Prashant Jha², Ashley Barfield¹, Fagner Rontani², Bhupesh Dhaka², Giulia Bortolon², Connor McKoin²; (1)LSU AgCenter, St. Joseph, LA, (2)LSU AgCenter, Baton Rouge, LA (86)

Assessing the Safety of S-Metolachlor as an Over-the-Top Pre-Emergent Herbicide on 'Denver Daisy' Black-eyed Susan (*Rudbeckia hirta* 'Denver Daisy') David Nistler*¹, Anthony Bowden¹, Hannah Wright Smith¹, Daniel Rivera²; (1)University of Arkansas Division of Agriculture Research & Education, Little Rock, AR, (2)University of Arkansas Division of Agriculture SWREC, Hope, AR (87)

Evaluation of cover crops and herbicides for Texas panicum control in peanut Michael Marshall*¹, Alex Clobas-Celiz¹; (1)Clemson University, Blackville, SC (88)

Survey of Weed Species in North Carolina Sweetpotato (*Ipomoea batatas*) Kai Goble*¹, Lucas Lieber¹, Devon Carroll¹, Dennis Muc¹, Zachary Small¹, Samuel Crawford¹; (1)North Carolina State University, Raleigh, NC (89)

Efficacy of Saflufenacil on Fomesafen-Resistant Palmer amaranth Prakriti Dhaka*¹, Gulab Rangani¹, Nilda Roma-Burgos¹; (1)University of Arkansas, Fayetteville, AR (90)

Assessing the Potential for Poultry Litter in Reducing Residual Herbicide Injury to Brassica carinata Kayla Eason*¹, Samantha Bowen²; (1)USDA-ARS, Tifton, GA, (2)University of Georgia, Tifton, GA (91)

Evaluating the Safety of PRE and POST Herbicides on Bambara Nuts (Vigna subterranea) When Applied in the Greenhouse and Field Samuel Crawford*¹, Lucas Lieber¹, Devon Carroll¹, Dennis Muc¹, Jonathan Schultheis¹, Adrienne Gorny¹, Zachary Small¹; (1)North Carolina State University, Raleigh, NC (92)

Weed Control with Fluridone in Peanut in North Carolina Ethan Foote*¹, David Jordan¹; (1)North Carolina State University, Raleigh, NC (93)

Surtain™ Herbicide: A New Residual Herbicide for Weed Control in Corn from BASF Corporation. Sanjeev Bangarwa*¹, Sandra Ethridge¹, Josh Putman¹; (1)BASF Corporation, Research Triangle Park, NC (94)

Regrowth from mown winter cover crops as a termination method extends ground cover Gustavo Camargo Silva*¹, Muthukumar Bagavathiannan¹; (1)Texas A&M University, College Station, TX (95)

Dose-response and shikimic acid accumulation on Palmer amaranth biotypes from Georgia. Pedro Augusto Silva Martins*¹, Heytor Lemos Martins², Samantha Bowen¹, Pedro Luis da Costa Aguiar Alves², Timothy Grey¹, Juliana de Souza Rodrigues¹; (1)University of Georgia, Tifton, GA, (2)Sao Paulo State University, Jaboticabal (96)

Exploration of sweetpotato germplasm response to anaerobic soil disinfestation, weed competition and southern root-knot nematode resistance. Simardeep Singh*¹, Churamani Khanal², Matthew Cutulle¹; (1)Clemson University, Coastal Research and Education Center, Charleston, SC, (2)Clemson University, Clemson, SC (97)

Effect of novel nanocellulose-based adjuvant (BioGrip®) on Dicamba volatilization Diego Rodriguez*¹, Juan Camilo Velasquez¹, Thomas Butts², Joseph Batta-Mpouma³, Gurshagan Kandhola³, Nilda Roma-Burgos⁴; (1)University of Arkansas, Fayetteville, AR, (2)Purdue University, Lafayette, IN, (3)Celludot, LLC, Fayetteville, AR, (4)University of Arkansas, Fayetteville, AR (98)

Assessing Effective Germination Methods of Amaranthus Species: A Greenhouse Study Debra Smitherman*¹, David Russell¹, J. Scott McElroy¹; (1)Auburn University, Auburn, AL (99)

See&Spray where are we going

Lauren Lazaro*¹, (1)Blue River Technology, Santa Clara, CA (100)

Southeasternflora.com a resource weed scientists need

John Byrd*¹, John Gwaltney², Charles Bryson³; (1)Mississippi State University, Mississippi State, MS, (2)CEO Forestry Suppliers, Inc., Jackson, MS, (3)USDA-ARS, Retired, Starkville, MS (101)

Exploring Weed-Suppression Potential Using Different Cotton Cultivars

Megan Singletary*¹, Peter Dotray², Carol Kelly³, Muthu Bagavathiannan⁴, Matthew Woolard¹, Bobby Rodriguez³; (1)Texas Tech University, Lubbock, TX, (2)Texas A&M AgriLife Research and Extension Service, Texas Tech University, Lubbock, TX, (3)Texas A&M AgriLife Research and Extension Service, Lubbock, TX, (4)Texas A&M University, College Station, TX (102)

Evaluation of pyroxasulfone + carfentrazone coated fertilizer applications in cotton Caroline Wayhs Backes*¹, Zachary Howard¹, Scott Nolte¹; (1)Texas A&M University, College Station, TX (103)

Cover Crop and Sprayer Sensitivity Setting Influence on See & Spray™ Ultimate vs See & Spray™ Premium

Diego Contreras*¹, Brittany Pendleton¹, Colden Bradshaw¹, Jackson Alsdorf¹, Ronel Argueta¹, Lauren Lazaro³, Charles Cahoon¹, Wesley Everman²; (1)North Carolina State University, Raleigh, NC, (2)Iowa State University, Ames, IA, (3)Blue River Technology, Santa Clara, CA (104)

WEEDS: A Multiregional Decision Support System for Integrated Weed Management

Purushottam Gyawali*¹, Karen Lindsey², Steven Mirsky³, Michael Popp², Jason Norsworthy⁴, Muthukumar Bagavathiannan¹; (1)Department of Soil and Crop Sciences, Texas A&M University, College Station, TX, (2)Department of Agricultural Economics and Agribusiness, University of Arkansas, Fayetteville, AR, (3)United States Department of Agriculture, Agricultural Research Service, Beltsville Agricultural Research Center, Sustainable Agricultural Systems Laboratory, Beltsville, MD, (4)Department of Crop, Soil, and Environmental Sciences, University of Arkansas, Fayetteville, AR (105)

Elucidating the Protective Mechanism of Melatonin in Cotton Against 2,4-D Herbicide-Induced Damage

Josiane Argenta*¹, Te Ming Tseng¹; (1)Mississippi State University, Starkville, MS (106)

Environmental factors affecting khakiweed (*Alternanthera pungens*) germination Annabelle McEachin*¹, Timothy Grey¹, Nicholas Basinger, Juliana de Souza Rodrigues¹, (1)University of Georgia, Tifton, GA (107)

Efficacy and economic impacts of weed control and fertility management practices in Texas pastures. Scott Nolte*², Keegan Crawford¹, Zachary Howard²; (1)Texas A&M University, College Station, TX , (2)Texas A&M AgriLife Extension Service, College Station, TX (108)

Studies on multiple herbicide-resistant Barnyardgrass (*Echinochloa crus-galli*) in Texas Rice Willian Felipe Larini*¹, Fidel González-Torralva¹, Muthukumar V Bagavathiannan¹, Samer Rustom¹, Nithya K Subramanian¹; (1)Department of Soil and Crop Sciences, Texas A&M University, College Station, TX (109)

Exploring Nicosulfuron Combinations for Broad-spectrum Weed Control in Warm-Season Turf Suzannah Hale*¹, John Peppers¹, Bret Corbett¹, Shawn Askew¹; (1)Virginia Tech, Blacksburg, VA (110)

Evaluation of soybean weed management in absence of synthetic auxin herbicides Colden Bradshaw*¹, Diego Contreras¹, Jackson Alsdorf¹, Ronel Argueta¹, Wesley Everman¹; (1)North Carolina State University, Raleigh, NC (111)

Can spray volume and nozzle selection reduce early-season cotton injury from herbicide tank mixes? Jose de Sanctis*¹, Charles Cahoon¹, Zachary Taylor¹, Jacob Forehand¹, Brock Dean¹, Hunter Lee¹; (1)North Carolina State University, Raleigh, NC (112)

MONDAY AFTERNOON JANUARY 20

General Session

LOCATION: Crystal C&D
TIME: 1:00 PM - 5:00 PM
Eastern Time
CHAIR & MODERATOR: Eric Palmer
Syngenta
Greensboro, NC

***SPEAKER**

- 01:00 PM Welcome and Announcements.** E. Palmer*; Syngenta Crop Protection LLC, Greensboro, NC
- 01:05 PM Welcome to South Carolina.** P. Wechter*; Coastal Research and Extension Center, Charleston, SC
- 01:15 PM Keynote Speaker.** D. Shields*; University of South Carolina, Columbia, SC
- 01:45 PM Presidential Address.** T. Baughman*; Texas A&M Agrilife Research and Extension Center, Lubbock, TX
- 02:00 PM History of the SWSS Endowment Fund.** R. Ratliff*; Stillwater, OK
- 02:25 PM ESA Herbicide Strategy Overview.** T. Burd*; Syngenta Crop Protection, Vero Beach, FL
- 02:40 PM ESA Herbicide Strategy: Working together to simplify the process for farmers.** S. Culpepper*; University of Georgia, Tifton, GA
- 03:00 PM Break**
- 03:10 PM Washington DC Update.** L. Van Wychen*; Executive Director of Science Policy, Alexandria, VA

- 03:30 PM 2024 SWSS Endowment Enrichment Scholarship Presentation.** P. Carvalho-Moore*; University of Arkansas, Fayetteville, AR
- 03:45 PM 2024 SWSS Endowment Enrichment Scholarship Presentation.** R. Hamburg*; Texas A&M University, College Station, TX
- 04:00 PM 2024 SWSS Endowment Enrichment Scholarship Presentation.** G. Silva, Texas A&M University, College Station, TX
- 04:15 PM The making of the broken hoe trophy.** S. Askew*; Virginia Tech, Blacksburg, VA
- 04:35 PM Adjourn**
- 05:00 PM SWSS Business Meeting**

TUESDAY MORNING JANUARY 21

Graduate Student Oral Presentation Contest

LOCATION: Crystal C
TIME: 7:30 AM - 12:15 PM ET
CHAIR: Hannah Wright-Smith
University of Arkansas
System Division of
Agriculture
Lonoke, AR

MODERATOR: Hannah Wright-Smith
University of Arkansas
System Division of
Agriculture
Lonoke, AR

***SPEAKER † STUDENT CONTEST**

- 07:30 AM †Impact of glufosinate on sugarcane yield and yield components when applied post-directed and its efficacy in controlling emerged itchgrass (*Rottboellia cochinchinensis*).**
Warner Simon*¹, Albert Orgeron¹, Matthew Foster¹, Alice Wright²; (1)LSU AgCenter, Sugar Research Station, St. Gabriel, LA,
(2)USDA-ARS, Sugarcane Research Unit, Houma, LA (113)
- 07:45 AM †Full Season Weed Control with Oxyfluorfen in a Furrow Irrigated Rice Production System**
Thomas Eubank*¹, Jason Bond¹, Gregory Mangialardi¹, Dalton Whitt¹, Tanner King¹, Jacob Dodd¹; (1)Mississippi State University, Starkville, MS (114)

- 08:00 AM** †**Comparison of Tetflupyrolimet Application Methods as a Preemergence Herbicide in Rice (*Oryza Sativa* L.)**
Gavin Sparks*¹, Connor Webster¹, Maranda Hains¹, Ben Stoker¹, Wesley Carr¹, Eve Williams¹; (1)LSU Ag Center, Baton Rouge, LA **(115)**
- 08:15 AM** †**Sequential Application Timings for Glufosinate in Cotton and Soybean**
Tanner King*¹, Gregory Mangialardi¹, Thomas Eubank¹, Dalton Whitt¹, Lindsey Bell¹, Jason Bond¹; (1)Mississippi State University, Stoneville, MS **(116)**
- 08:30 AM** †**Optimal Application Rates of Tetflupyrolimet and Clomazone Mixtures on a Medium Soil**
Maranda Hains*¹, Connor Webster¹, Wesley Carr¹, Ben Stoker¹, Gavin Sparks¹, Eve Williams¹; (1)Louisiana State University, Baton Rouge, LA **(117)**
- 08:45 AM** †**Evaluation of Different Herbicide Programs Incorporating Topramezone and Liberty ULTRA POST in Axant™ Flex Cotton**
Matthew Woolard*¹, Peter Dotray², Adam Hixson³, Megan Singletary¹, Brad Guice⁴; (1)Texas Tech University, Lubbock, TX, (2)Texas Tech University, Texas A&M AgirLife Research and Extension Service, Lubbock, TX, (3)BASF, Lubbock, TX, (4)BASF, Winnsboro, LA **(118)**
- 09:00 AM** †**Tolerance of Southern Crops to Tetflupyrolimet** Dalton Whitt*¹, Henry Edwards¹, Lindsey Bell¹, Greg Mangialardi¹, Thomas Eubank¹, Jacob Dodd¹, Jason Bond¹; (1)Mississippi State University, Stoneville, MS **(119)**
- 09:15 AM** †**Effect of Rainfall Timing on Herbicide-Coated Fertilizer Efficacy**
Brock Dean*¹, Charles Cahoon¹, Zachary Taylor¹, Hunter Lee¹, Clark Roberts¹; (1)North Carolina State University, Raleigh, NC **(120)**
- 09:30 AM** †**Impact of Pre-Emergent Residual Herbicide Activity on Soybean Systems in Oklahoma**
Karina Beneton*¹, Liberty Galvin¹, Todd Baughman²; (1)Oklahoma State University, Stillwater, OK, (2)Texas A&M University, Lubbock, TX **(121)**

- 09:45 AM** †**The Effect of Preemergence Residual Herbicides on the Critical Time of Weed Removal in Soybean [Glycine max (L.) Merr.]**
Ben Stoker*¹, Daniel Stephenson², Connor Webster¹, Roberto Fritsche Neto³, Maranda Hains¹, Gavin Sparks¹, Wesley Carr¹
Eve Williams¹; (1)LSU AgCenter, Baton Rouge, LA, (2)LSU AgCenter, Alexandria, LA, (3)LSU AgCenter, Crowley, LA **(122)**
- 10:00 AM** **Break**
- 10:15 AM** †**Are Residual Herbicides Applied Postemergence Safe for Soybean?**
Jacob Dodd*¹, Lindsey Bell¹, Matt Edwards¹, Thomas Eubank¹, Gregory Mangialardi¹, Dalton Whitt¹, Jason Bond¹; (1)Mississippi State University, Stonville, MS **(123)**
- 10:30 AM** †**Optimizing Weed Control Programs in Soybean Utilizing See & Spray™ Technology**
Sydney Baker Holley*¹, Luis Avila¹, Darrin Dodds¹, Antonio Augusto Tavares¹, Lucas Rector¹, Nestor Cordero¹; (1)Mississippi State University, Mississippi State, MS **(124)**
- 10:45 AM** †**Evaluation of herbicide-coated fertilizer spread over the top of late season soybeans for Italian ryegrass control** Colden Bradshaw*¹, Brock Dean¹, Zachary Taylor¹, Charles Cahoon¹; (1)North Carolina State University, Raleigh, NC **(125)**
- 11:00 AM** †**Measuring Length of Residual Control as Influenced by Cover Crop and Herbicide Using See & Spray™ Technology** Brittany Pendleton*¹, Diego Contreras¹, Colden Bradshaw¹, Jackson Alsdorf¹, Ronel Argueta¹, Charles Cahoon¹, Wesley Everman², Lauren Lazaro³; (1)North Carolina State University, Raleigh, NC, (2)Iowa State University, Ames, IA, (3)Blue River Technology, Santa Clara, CA **(126)**
- 11:15 AM** †**Management of Herbicide-Resistant Italian Ryegrass Utilizing Cover Crops and Fall Residual Herbicides** Connor Mckoin*¹, Donnie Miller¹, Prashant Jha¹, Ashley Barfield¹, Bhupesh Dhaka¹, Giulia Bortolon¹; (1)Louisiana State University AgCenter, Baton Rouge, LA **(127)**

11:30 AM †**Effectiveness of See & Spray™ Ultimate as Influenced by Cover Crop and Preemergence Herbicide Program**
Diego Contreras*¹, Brittany Pendleton¹, Colden Bradshaw¹, Jackson Alsdorf¹, Ronel Argueta¹, Lauren Lazaro, Charles Cahoon¹, Wesley Everman²; (1)North Carolina State University, Raleigh, NC, (2)Iowa State University, Ames, IA
(128)

11:45 AM †**Investigating Amaranthus Spp. Response to Glufosinate, Saflufenacil, and Trifludimoxazin**
Debra Smitherman*¹, David Russell¹, Jinesh Patel¹, Claudia Ann Landrum¹, Aniruddha Maity¹, Ingo Meiners², Aimone Porri³, Jens Lerchl³, J. Scott McElroy¹; (1)Auburn University, Auburn, AL (2)BASF, Raleigh, NC, (3)BASF, Ludwigshafen
(129)

12:00 PM †**Influence of Application Method on Palmer Amaranth** Colton Fuller*¹; (1)University of Tennessee, Jackson, TN **(130)**

12:15 PM **END OF SESSION**

TUESDAY MORNING JANUARY 21

Graduate Student Oral Presentation Contest

LOCATION: Crystal D
TIME: 7:30 AM - 12:15 PM ET
CHAIR: Hannah Wright-Smith
University of Arkansas
System Division of
Agriculture
Lonoke, AR

MODERATOR: Hannah Wright-Smith
University of Arkansas
System Division of
Agriculture
Lonoke, AR

***SPEAKER † STUDENT CONTEST**

07:30 AM †Impacts of Saline Conditions on Organic Watermelon Production in the Southeastern US
Joseph Bazzle*¹, Matthew Cutulle², Brian Ward²;
(1)Clemson University, Clemson, SC, (2)Clemson University, Charleston, SC **(131)**

07:45 AM †Evaluation of Anaerobic Soil Disinfestation with Different Carbon Sources to Manage Weeds and Nematodes in Sweetpotato. Simardeep Singh*¹, Churamani Khanal², Brian Ward¹, Matthew Cutulle¹; (1)Clemson University, Coastal Research and Education Center, Charleston, SC, (2)Clemson University, Clemson, SC **(132)**

- 08:00 AM** †**Evaluation of Soil Steaming as a Control Method for Yellow Nutsedge (*Cyperus esculentus*) Tubers Across Different Seedling Depths Under Controlled Conditions**
Alaina Richardson*¹, Ncomiwe Maphalala¹, John Arnold¹, Ayman Almashwali¹, Bruna Dal’Pizol Novello¹, Worlayno Segbefia¹, Alyssa Miller¹, Teming Tseng¹; (1)Mississippi State University, Starkville, MS **(133)**
- 08:15 AM** †**Evaluating the Efficacy of Anaerobic Soil Disinfestation for Weed Management in Organic Watermelon Production** Sohaib Chattha*¹, Brian Ward¹, Matthew Cutulle¹; (1)Clemson University, Coastal Research and Education Center, Charleston, SC **(134)**
- 08:30 AM** †**Determining the critical period for weed control in short-stature corn system in Georgia**
Kamana Pilania*¹, Michael Christian Bocz¹, Hannah Carol Lindell¹, Charles Edward Smith III¹, Himani Ahlawat¹, Priscila Campos¹, Nicholas Basinger¹, (1)University of Georgia, Athens, GA **(135)**
- 08:45 AM** †**Can Salt-Tolerant Rice Improve Weed Management in Organic Production within Partial Saltwater Agroecosystems?** Gursewak Singh*¹, Brian Ward¹, Sarah White², Raghupathy Karthikeyan², Jai Rohila³, Michael Marshall⁴, Prasanta Subudhi⁵, Matthew Cutulle¹; (1)Clemson University, Coastal Research and Education Center, Charleston, SC, (2)Clemson University, Clemson, SC, (3)USDA ARS, Dale Bumpers National Rice Research Center, Stuttgart, AR, (4)Clemson University, Edisto Research & Education Center, Blackville, SC, (5)Louisiana State University, Baton Rouge, LA **(136)**
- 09:00 AM** †**Planting Green: Does it work for weed management in cotton?** Himani Ahlawat*¹, Hannah Carol Lindell¹, Charles E Smith III¹, Priscila Campos¹, Kamana Pilania¹, M. Chris Bocz¹, Nicholas Basinger¹; (1)University of Georgia, Athens, GA **(137)**
- 09:15 AM** †**Integrated Weed Management Tactics in Organic Cotton in the Texas High Plains**
Megan Singletary*¹, Peter Dotray², Katie Lewis², Joseph Burke³, Muthu Bagavathiannan⁴, Matthew Woolard¹, Bobby Rodriguez³; (1)Texas Tech University, Lubbock, TX, (2)Texas A&M AgriLife Research and Extension Service, Texas Tech

CONVENTION CENTER & MEETING ROOMS CAPACITY

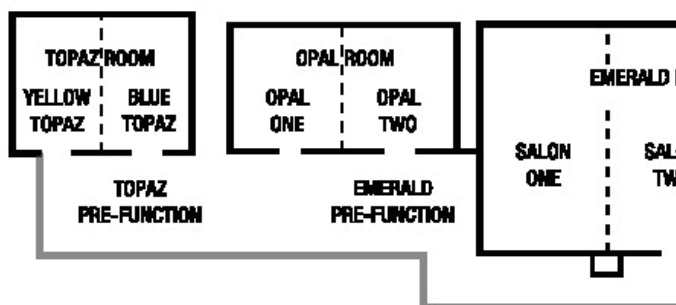

TIES

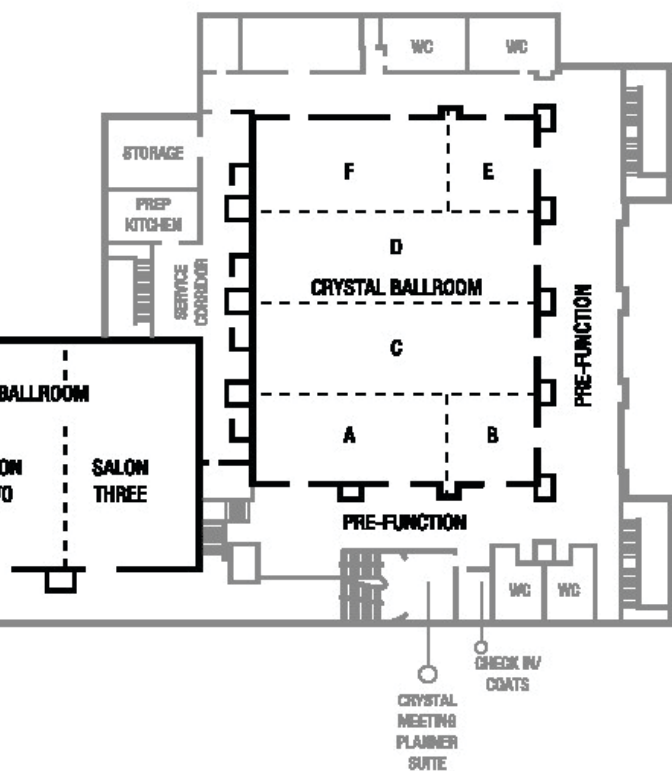

University, Lubbock, TX, (3)Texas A&M AgriLife Research and Extension Service, Lubbock, TX, (4)Texas A&M University, College Station, TX (138)

- 09:30 AM** †**Balancing Weed Control and Environmental Protection: Atrazine Mitigation through See and Spray Technology** Michael Dodde*¹, Jason Norsworthy¹, Tristen Avent¹, Lane Pierce¹, Ryan Henry², Bryan Young³, Marcelo Zimmer³, Lawrence Steckel⁴, Jared Buck⁴, Wesley Everman⁵, Diego Contreras⁵; (1)University of Arkansas System Division of Agriculture, Fayetteville, AR, (2)UPL NA Inc., Fort Wayne, IN, (3)Purdue University, West Lafayette, IN, (4)University of Tennessee, Jackson, TN, (5)North Carolina State University, Raleigh, NC (139)
- 09:45 AM** †**Evaluation of Sweetpotato (*Ipomoea batatas*) Variety Tolerance to Different Herbicide Treatments Under Controlled Conditions** Alyssa Miller*¹, Te Ming Tseng¹, Lorin Harvey¹, Alaina Richardson¹, Josiane Argenta¹, Ncomiwe Maphalala¹; (1)Mississippi State University, Mississippi State, MS (140)
- 10:00 AM** **Break**
- 10:15 AM** †**Development of a Threshold Model for Real-Time Weed Detection and Herbicide Application in Turfgrass** Samuel Kreinberg*¹, Jason Davis², Michael Richardson¹, Hannah Wright-Smith³, Wendell Hutchens¹; (1)University of Arkansas, Fayetteville, AR, (2)University of Arkansas, Batesville, AR, (3)University of Arkansas, Little Rock, AR (141)
- 10:30 AM** †**Microclimate Influence on Home Lawn Weed Species Distribution** Chih Julie Wang*¹, Alberto Novello¹, Audrey Young¹, Gerald Henry¹, Jay McCurdy², David Held³; (1)University of Georgia, Athens, GA, (2)Mississippi State University, Starkville, MS, (3)Auburn University, Auburn, AL (142)
- 10:45 AM** †**Evaluating the Effect of Ground Speed on the Spray Patterns of Boomless Nozzles** Thomas Duncan*¹, John Byrd¹, Kayla Broster¹, Chris Gregory¹, Daniel Chesser¹; (1)Mississippi State University, Starkville, MS (143)

- 11:00 AM** †**Investigating the Effects of Preemergence Herbicides on Spring Beauty (*Claytonia virginica*) Growth in Flowering Turfgrass Lawns** Nikolay Minaev*¹, Jay McCurdy¹, Edicarlos de Castro¹; (1)Mississippi State University, Mississippi State, MS **(144)**
- 11:15 AM** †**Using Squash and Green Beans as Bioindicators for Aminopyralid Herbicide Carryover in Soil** Charles E. Smith III*¹, Hannah Carol Lindell¹, M. Chris Bocz¹, Himani Ahlawat¹, Nicholas Basinger¹; (1)University of Georgia, Athens, GA **(145)**
- 11:30 AM** †**Impact of Herbicides from Different Modes of Action on Weedy Flower Morphology and Pollinator Foraging in Turfgrass** Navdeep Godara*¹, Shawn Askew¹; (1)Virginia Tech, Blacksburg, VA **(146)**
- 11:45 AM** †**Strategies for Managing Glyphosate-Resistant Palmer Amaranth in Roundup Ready Alfalfa** Roger Furlan Jr*¹, Bruno Pedreira¹, Lawrence Steckel¹, Renata Oakes¹, Thomas Mueller¹; (1)University of Tennessee, Knoxville, TN **(147)**
- 12:00 PM** †**Influence of Rainfall Timing on the Efficacy of Hexazinone and Quinclorac for the Control of Knotroot Foxtail (*Setaria parviflora*)** Tunde Akanbi*¹, David Russell¹, Forrest Davis¹; (1)Auburn University, Auburn, AL **(148)**
- 12:15 PM** **END OF SESSION**

TUESDAY MORNING JANUARY 21

Graduate Student Oral Presentation Contest

LOCATION: Crystal F
TIME: 7:30 AM - 12:15 PM ET
CHAIR: Hannah Wright-Smith
University of Arkansas
System Division of
Agriculture
Lonoke, AR

MODERATOR: Hannah Wright-Smith
University of Arkansas
System Division of
Agriculture
Lonoke, AR

***SPEAKER † STUDENT CONTEST**

**07:30 AM † Investigating a multiple-resistant Palmer
amaranth population from North Carolina**
Ronel Argueta ^{*1}, Diego Contreras¹, Colden
Bradshaw¹, Jackson Alsdorf¹, Charles Cahoon¹,
Wesley Everman¹; (1)North Carolina State
University, Raleigh, NC **(149)**

**07:45 AM † Long-term Impact of Integrated Weed
Management Practices on Palmer Amaranth in
Cotton** Cory Ketchum^{*1}, Jason Norsworthy¹, Tom
Barber¹, Rodger Farr², Ty Smith³, Tristen Avent¹,
Lane Pierce¹; (1)University of Arkansas System
Division of Agriculture, Fayetteville, AR, (2)Bayer
Crop Science, Wellfleet (3)Simplot Grower
Solutions, Shallowater **(150)**

- 08:00 AM** †**Distribution of Herbicide Resistant Palmer amaranth in North Carolina** Jackson Alsdorf*¹, Diego Contreras¹, Ronel Argueta¹, Colden Bradshaw¹, Charles Cahoon¹, Katherine Jennings¹, Wesley Everman¹; (1)North Carolina State University, Raleigh, NC **(151)**
- 08:15 AM** †**Optimization of a Yield Loss Prediction Model Based on Aerial Imagery** Avi Goldsmith*¹, Robert Austin¹, Charles Cahoon¹, Ramon Leon¹; (1)North Carolina State University, Raleigh, NC **(152)**
- 08:30 AM** †**Identifying the Source of ALS-Inhibitor Resistance in White Margin Sedge and Discussing Possible Control Options** Aidan D. Ross*¹, Jason Norsworthy¹, Susee Sudhakar¹; (1)University of Arkansas System Division of Agriculture, Fayetteville, AR **(153)**
- 08:45 AM** †**Memory Response of Senecio madagascariensis Plant Cohorts to Heat Stress** Tamara Heck*¹, Luis Avila², Gustavo Maia Sousa³, Roque Mauricio Palacios-Zuñiga³; (1)Federal University of Pelotas, Mississippi State University, Pelotas/RS, (2)Mississippi State University, Starkville, MS, (3)Federal University of Pelotas, Pelotas/RS **(154)**
- 09:00 AM** †**Competition dynamics between early-emerging Echinochloa colona and hybrid rice** Diego Rodriguez*¹, Juan Velasquez², Guido Plaza³, Nilda Burgos¹, Maria Fernanda Alvarez⁴, Eduardo Graterol⁵; (1)University of Arkansas, Fayetteville, AR, (2)University of Arkansas, Fayetteville, AR, (3)Universidad Nacional de Colombia, Bogotá, (4)International Centre for Tropical Agriculture (CIAT), Cali, (5)Latin American Fund for Irrigated Rice (FLAR), Cali **(155)**
- 09:15 AM** †**Transcriptome and phenotype of junglerice after iterative exposure to florpyrauxifen-benzyl and heat stress** Juan Velasquez*¹, Prakriti Dhaka¹, Giovana De Carvalho¹, Diego Rodriguez¹, Gulab Rangani¹, Nilda Roma-Burgos¹; (1)University of Arkansas, Fayetteville, AR **(156)**

- 09:30 AM** †**Peanut Response to Repeated Organic Herbicide Applications** Samantha Bowen*¹, Kayla Eason², Timothy Grey¹; (1)University of Georgia, Tifton, GA, (2)USDA-ARS, Tifton, GA **(157)**
- 09:45 AM** †**From Cover to Crop: Integrating Cereal Grains for Sustainable Weed Management in Georgia Peanuts** Hannah Lindell*¹, Samantha Bowen², Charles Smith III¹, Kayla Eason³, Michael Bocz¹, Timothy Grey², Nicholas Basinger¹; (1)University of Georgia, Athens, GA, (2)University of Georgia, Tifton, GA, (3)US Department of Agriculture, Tifton, GA **(158)**
- 10:00 AM** **Break**
- 10:15 AM** †**Herbicide Efficacy for Early Termination of Cover Crops in Tennessee** James Ward*¹, Jake McNeal¹, Lawrence Steckel¹, Frank Yin¹, Virginia Sykes¹, Nutifafa Adotey¹; (1)University of Tennessee, Knoxville, TN **(159)**
- 10:30 AM** †**Evaluation the Efficacy of Cereal Rye Cover Crop on Weed Control in Peanut** Ethan Foote*¹, David Jordan¹; (1)North Carolina State University, Raleigh, NC **(160)**
- 10:45 AM** †**Comparison of Single and Sequential Applications of Quizalofop on TamArk™ and Double Team™ Grain Sorghum** Wesley Herrman*¹, Jason Norsworthy¹, L Barber², Tristen Avent¹, Pamela Carvalho-Moore¹; (1)University of Arkansas System Division of Agriculture, Fayetteville, AR; (2)University of Arkansas System Division of Agriculture, Newport, AR **(161)**
- 11:00 AM** †**Developing Weed Control Strategies for Edamame (Glycine max (L.)): The Role of Cover Crops and Cultivar Selection** Akashdeep Singh Brar*¹, Michael Flessner², Bo Zhang², Mark Reiter¹, Vijay Singh¹; (1)Eastern Shore Agricultural Research and Extension Center, Virginia Tech, Painter, VA, (2)School of Plant and Environmental Sciences, Virginia Tech, Blacksburg **(162)**

- 11:15 AM** †**Weather Related Crop Response to Quizalofop in the Provisia Rice System** Wesley Carr*¹, Connor Webster¹, Ben Stoker¹, Maranda Hains², Gavin Sparks¹; (1)LSU AgCenter, Baton Rouge, LA , (2)LSU AgCenter, Baton Rouge, LA **(163)**
- 11:30 AM** †**Timing is everything: balancing rye planting dates and termination for soybean productivity and weed management.** Priscila Campos*¹, Michael Bocz¹, Hannah Lindell¹, Charles Smith¹, Himani Ahlawat¹, Fnu Kamana¹, John Wallace², Nicholas Basinger¹; (1)University of Georgia, Athens, GA, (2)Pennsylvania State University, University Park, PA **(164)**
- 11:45 AM** †**Imazapyr tolerance in Clearfield Sunflower (*Helianthus annuus*)** Chris Gregory*¹, John Byrd¹, Johnnie Thorne², Kayla Broster¹, Thomas Duncan¹; (1)Mississippi State University, Starkville, MS, (2)Mississippi Department of Transportation, Jackson, MS **(165)**
- 12:00 PM** †**Cereal rye cover crop inhibits johnsongrass rhizome growth** Gustavo Camargo Silva*¹, Muthukumar Bagavathiannan¹; (1)Texas A&M University, College Station, TX **(166)**
- 12:15 PM** **END OF SESSION**

TUESDAY AFTERNOON JANUARY 21

New Technologies

LOCATION: Crystal D
TIME: 2:30 PM – 4:45 PM ET
CHAIR: Lauren Lazaro
Blue River Technology
Sunnyvale, CA

MODERATOR: Lauren Lazaro
Blue River Technology
Sunnyvale, CA

***SPEAKER**

02:30 PM Determining energy requirements for weed seed mortality with mid-Infrared radiation Ryan Hamberg*¹, Sarah Chu¹, Muthu Bagavathiannan¹; (1)Department of Soil and Crop Sciences, Texas A&M University, College Station, TX **(167)**

02:45 PM Is Laser Energy Practical for Weed Management in Turfgrass? Juan Romero*¹, Navdeep Godara¹, Shawn Askew¹; (1)Virginia Tech, Blacksburg, VA **(168)**

03:00 PM Plant sterols: A broad-spectrum potential pre-emergent non-toxic herbicide Krishna Kumar*¹; (1)Griffing Biologics LLC, Texas, Texas A&M University, College Station, TX **(169)**

03:15 PM Differentiation of Male and Female Plants of Palmer Amaranth (*Amaranthus palmeri*) Using an RGB Sensor and Machine Learning Models: Classification and Detection. Bismark Anokye*¹; (1)Texas A&M University, College Station, TX **(170)**

- 03:30 PM Weed Size Impact on Post-Emergent Application Coverage using See & Spray™ in Soybean** Wyatt Stutzman*¹; Tristen Avent²; Jason Norsworthy²; Diego Contreras³; Wesley Everman³; Marcelo Zimmer⁴; Bryan Young⁴; Jared Buck⁵; Octavio Ransenberg⁵; Lawrence Steckel⁵; Michael Houston⁶; Lauren Lazaro⁷; William Patzoldt⁷; Michael Flessner¹; (1)Virginia Tech, Blacksburg, VA, (2)University of Arkansas, Fayetteville, AR, (3)North Carolina State University, Raleigh, NC, (4)Purdue University, West Lafayette, IN, (5)University of Tennessee Knoxville, Knoxville, TN, (6)Stoneville R&D, Stoneville, MS (7)Blue River Technology, San Diego, CA **(171)**
- 03:45 PM BREAK**
- 04:00 PM Enhancing the applicability of Precision Ag Technologies** Vijay Singh*¹, Akashdeep Singh Brar¹, Fatemeh Esmacilbeiki¹, Rutvij Wamanse¹, Milos Viric¹, Robert Cooley¹, Daniel Martin²; (1)Virginia Tech, Painter, VA, (2)United States Department of Agriculture, College Station, TX **(172)**
- 04:15 PM Integrating Machine Learning and Ground Robotics for Weed Management** Rutvij Wamanse*¹, Dhiraj Shrivastava², Robert Cooley¹, Vijay Singh¹; (1)Virginia Tech Eastern Shore AREC, Painter, VA, (2)Donald Danforth Plant Science Center, Saint Louis, MO **(173)**
- 04:30 PM What's New In Industry?** Kyle Russell*¹, Mark Kitt², Eric Palmer²; (1)Syngenta Crop Protection, LLC, Beasley, TX, (2)Syngenta Crop Protection LLC, Greensboro, NC **(174)**
- 04:45 PM END OF SESSION**

TUESDAY AFTERNOON JANUARY 21

Forest Vegetation Management

LOCATION: Opal Two
TIME: 2:00 PM – 2:30 PM ET
CHAIR: David Clabo
University of Georgia
Athens, GA
MODERATOR: David Clabo
University of Georgia
Athens, GA

***SPEAKER**

- 02:00 PM Chemical Site Preparation with TerraVue, Imazapyr, and other Auxin Herbicides and Planted Loblolly Pine First Year Response**
David Clabo*¹, David Dickens²; (1)University of Georgia Warnell School of Forestry, Tifton, GA, (2)University of Georgia Warnell School of Forestry & Natural Resources, Statesboro, GA **(175)**
- 02:15 PM Efficacy of TerraVue with Several Forestry Site Preparation Herbicide Tank Mixes on an Upper Coastal Plain Site in Georgia.** David Clabo*¹, David Dickens²; (1)University of Georgia Warnell School of Forestry & Natural Resources, Tifton, GA, (2)University of Georgia Warnell School of Forestry & Natural Resources, Statesboro, GA **(176)**
- 02:30 PM END OF SESSION**

TUESDAY AFTERNOON JANUARY 21

**Soil and Environmental Aspects of Weed
Science**

LOCATION: Opal Two
TIME: 3:00 PM - 3:45 PM ET
CHAIR: Kayla Eason
USDA
Tifton, GA

MODERATOR: Kayla Eason
USDA
Tifton, GA

***SPEAKER**

- 03:00 PM Biochar-herbicide interactions governing control of Palmer Amaranth and crowfoot grass in the light textured soil of Alabama** Rakesh Ghosh*¹, Nisith Purohit¹, Andrew Price², Steve Prior³, Aniruddha Maity¹; (1)Auburn University, Auburn, AL, (2)USDA-ARS National Soil Dynamics Laboratory, Auburn, AL, (3)USDA-ARS National Soil Dynamics Laboratory, Auburn, AL **(177)**
- 03:15 PM Herbicide Impregnated onto Dry Fertilizer: Efficacy and Concentrations in mixed loads** Thomas Mueller*¹, Lawrence Steckel², Gregory Stapleton³, Matthew Inman⁴; (1)UTIA, Knoxville, TN, (2)UTIA, Jackson, TN, (3)BASF, Dyersburg, TN, (4)BASF, Research Triangle Park, NC **(178)**
- 03:30 PM Hydrilla turion growth response to water temperature** Timothy Grey*¹, Kayla Eason², Samantha Bowen¹, Benjamin Sperry³; (1)University of Georgia, Tifton, GA, (2)USDA/ARS, Tifton, GA, (3)US Army Engineer Research & Development Center, Gainesville, FL **(179)**
- 03:45 PM END OF SESSION**

TUESDAY AFTERNOON JANUARY 21

Weed Management in Pastures and Rangeland

LOCATION: Opal One
TIME: 2:00 PM - 2:45 PM ET
CHAIR: Kayla Broster
Mississippi State University
Starkville, MS
MODERATOR: Kayla Broster
Mississippi State University
Starkville, MS

***SPEAKER**

- 02:00 PM Postemergence options for management of foxtail species in bermudagrass pastures.** Nicholas Basinger*¹, Michael Bocz¹, Hannah Lindell¹, Charles Smith III¹, Himani Ahlawat¹; (1)University of Georgia, Athens, GA **(180)**
- 02:15 PM Evaluating Hemp Dogbane (*Apocynum cannabinum* L.) and Green Antelopehorn Milkweed (*Asclepias viridis* Walter) Response to Auxins used in Pastures and ROWs** Kayla Broster*¹, John Byrd¹, Chris Gregory¹, Thomas Duncan¹, Johnnie Thorne²; (1)Mississippi State University, Starkville, MS, (2)Mississippi DOT, Newton, MS **(181)**
- 02:30 PM Annual and Perennial Sandbur (*Cenchrus* spp.) Management Effects in Hayfield and Pastures with Indaziflam & Glyphosate** Zachary Howard*¹, Scott Nolte¹, Case Medlin²; (1)Texas A&M AgriLife Extension, College Station, TX , (2)Environmental Science US LLC, Cary, NC **(182)**
- 02:45 PM END OF SESSION**

TUESDAY AFTERNOON JANUARY 21

Educational Aspects of Weed Control

LOCATION: Opal Two
TIME: 4:00 PM - 4:15 PM ET
CHAIR: Nick Basinger
University of Georgia
Athens, GA

MODERATOR: Nick Basinger
University of Georgia
Athens, GA

***SPEAKER**

04:00 PM How our discipline began.
John Byrd*¹, David Russell², Chris Gregory¹, Kayla
Broster¹, Hayden Duncan¹; (1)Mississippi State
University, Mississippi State, MS, (2)Auburn
University, Auburn, AL **(183)**

04:15 PM END OF SESSION

TUESDAY AFTERNOON JANUARY 21

Weed Management in Agronomic Crops

LOCATION: Crystal C
TIME: 4:00 PM - 5:00 PM ET
CHAIR: Pete Eure
Syngenta Crop Protection
Greensboro, NC

MODERATOR: Brock Dean
NC State University
Raleigh, NC

***SPEAKER**

- 04:00 PM** **Suppression by Cover Crops in Southern Crop Production Systems: A Meta-Analysis.** Amar Godar*¹, Jason Norsworthy¹; University of Arkansas, Fayetteville, AR **(184)**
- 04:15 PM** **Combining Cover Crops and Preemergence Herbicides to Extend Weed Suppression in Soybeans.** Forrest Davis*¹, David Russell¹; Auburn University, Auburn, AL **(185)**
- 04:30 PM** **Rye cover crop termination timing effects on weeds, insects, and seedling disease in Florida corn production.** Carlene Chase*¹, Solomon Amissah¹, Parmeshwor Aryal¹, Daniel Boakye¹, Rashelle Matthiesen-Anderson², Alison Robertson², John Tooker³; (1)University of Florida, Gainesville, FL, (2)Iowa State University, Ames, IA, (3)Pennsylvania State University, University Park, PA **(186)**

04:45 PM Cereal rye (*Secale cereale* L.) response to allelochemicals produced by neighboring cereal rye plants. Aliyah Warris*¹, James Holland², Virginia Moore³, Chris Reberg-Horton¹, Steven Mirsky⁴, Ramon Leon¹; (1)North Carolina State University, Raleigh, NC, (2)North Carolina State University, U.S. Department of Agriculture, Agricultural Research Service, Raleigh, NC, (3)Cornell University, Ithaca, NY, (4)U.S. Department of Agriculture, Agricultural Research Service, Beltsville, MD **(187)**

05:00 PM END OF SESSION

WEDNESDAY MORNING JANUARY 22

Weed Management in Agronomic Crops

LOCATION: Classroom Crystal C
TIME: 8:00 AM - 11:30 AM ET
CHAIR: Pete Eure
Syngenta Crop Protection
Greensboro, NC

MODERATOR: Hannah Lindell
University of Georgia
Athens, GA

***SPEAKER**

- 08:00 AM Surtain™ Herbicide: Introduction of New Residual Premix for Corn Market.** Sanjeev Bangarwa*¹, Josh Putman¹, Ryan Aldridge², Mark Allan Howard², Harrison Ferebee², Clete Youmans³, John Guice⁴, Larry Newsom⁵, Douglas Findley¹; (1)BASF Corporation, Research Triangle Park, NC, (2)BASF Corporation, Pine Level, NC, (3)BASF Corporation, Dyersburg, TN, (4)BASF Corporation, Winnsboro, LA, (5)BASF Corporation, Tifton GA **(188)**
- 08:15 AM Strategies for controlling late-season vine weeds in field corn** Will Phillips*¹, Thomas Mueller¹, Lawrence Steckel²; (1)UTIA, Knoxville, TN, (2)UTIA, Jackson, TN **(189)**
- 08:30 AM Weed Management Programs for Control of Multiple Herbicide-Resistant Amaranthus Populations in Corn** B. David Black*¹, Marshall Hay¹, Jesse Haarmann¹, William Tice¹, Tom Beckett¹, Mark Kitt¹, David Belles¹; (1)Syngenta, Greensboro, NC **(190)**
- 08:45 AM Common Ragweed (*Ambrosia artemisiifolia*) and Italian Ryegrass (*Lolium perenne* ssp. *multiflorum*) Density Following the Use of a Redekop Seed Control Unit.** Eli Russell*¹, Wykle Greene¹, Kevin Bamber¹, Matthew Spoth¹, Michael Flessner¹; (1)Virginia Tech, Blacksburg, VA **(191)**

- 09:00 AM** **Integration of Cover Crops and Herbicides for Weed Control in Peanut** Gourav Chahal*¹, Carter Bonnell¹, Andrew Price², Steve Li¹, Audrey Gamble¹; (1)Auburn University, Auburn, AL, (2)USDA-ARS, Auburn, AL **(192)**
- 09:15 AM** **Weed Proliferation in Fields: The Unseen Impact of Poultry Litter Application in Alabama** Akashdeep Singh*¹, David Russell¹, Rishi Prasad¹, Aniruddha Maity¹; (1)Auburn University, Auburn, AL **(193)**
- 09:30 AM** **Integrated Management of Goosegrass (*Eleusine indica*) in Cotton** Wilfried Ouedraogo*¹, Aniruddha Maity¹; (1)Auburn University, Auburn, AL **(194)**
- 09:45 AM** **Elucidating Competitive Interactions Between Cotton and Multiple Weed Species in Diverse Mixes** Purushottam Gyawali*¹, Christoph Redwitz², Muthukumar Bagavathiannan¹; (1)Department of Soil and Crop Sciences, Texas A&M University, College Station, TX, (2)Julius Kühn-Institut (JKI), Federal Research Centre for Cultivated Plants, Institute for Plant Protection in Field Crops and Grassland, Messeweg 11-12, D-38104 Braunschweig **(195)**
- 10:00 AM** **Break**
- 10:15 AM** **Does Preemergence Herbicide Strength Impact See & Spray™ Performance in Cotton?** Lane Pierce*¹, Jason Norsworthy¹, Tristen Avent¹, Michael Dodde¹; (1)University of Arkansas System Division of Agriculture, Fayetteville, AR **(196)**
- 10:30 AM** **Performance of Targeted Applications with See & Spray™ in Cotton** Tristen Avent*¹, Jason Norsworthy¹, Lane Pierce¹, Michael Dodde¹, Lauren Lazaro²; (1)University of Arkansas, Fayetteville, AR, (2)Blue River Technology, Santa Clara, CA **(197)**
- 10:45 AM** **Efficacy of trinexapac and herbicide mixtures on grass weeds and yellow nutsedge** Keith Andzej Monsalud*¹, Juan Camilo Velasquez Rodriguez¹, Prakriti Dhaka¹, Diego Rodriguez¹, Giovana de Carvalho Silva¹, Jianping Zhang¹, Nilda Roma Burgos¹; (1)University of Arkansas, Fayetteville, AR **(198)**

11:00 AM **Evaluating the Efficacy of Drop Nozzles and Reducing Downwind Drift in Cotton and Soybeans.** Christina Ward*¹, Scott Nolte¹, Gaylon Morgan², Brad Fritz³, Justin Calhoun⁴, Peter Dotray⁵, Todd Baughman⁶, Maxwell Smith⁷; (1)Texas A&M University, College Station, TX, (2)Cotton Incorporated, College Station, TX, (3)United States Department of Agriculture, College Station, TX, (4)University of Missouri, Columbia, MO, (5)Texas A&M University, Texas Tech University, Lubbock, TX, (6)Texas A&M University, Oklahoma State University, Lubbock, TX, (7)Oklahoma State University, Altus, OK **(199)**

11:15 AM **Does Cotton Response to Preemergence Herbicides Differ Between Bollgard® and ThryvOn™ Technologies?** James Malone*¹, L Barber¹, Jason Norsworthy¹, Ben Thrash¹; (1)University of Arkansas System Division of Agriculture, Fayetteville, AR **(200)**

11:30 AM **END OF SESSION**

WEDNESDAY MORNING JANUARY 22

Weed Management in Turf

LOCATION: Crystal D
TIME: 9:00 AM - 11:15 AM ET
CHAIR: Amy Wilbur
Mississippi State University
Starkville, MS
MODERATOR: Amy Wilbur
Mississippi State University
Starkville, MS

***SPEAKER**

- 09:00 AM Efficacy of Dodhylex™ Active (Tetflupyrolimet) for Annual Bluegrass and Smooth Crabgrass Control in Bermudagrass Turf** Jay McCurdy*¹, Amy Wilber¹, Ken Hutto²; (1)Mississippi State University, Starkville, MS, (2)FMC, Philadelphia, PA **(201)**
- 09:15 AM StriCore Herbicide: Evaluating Turfgrass Safety and Residual Control of Annual Grass Weeds on Fairways and Putting Greens** Kyle Briscoe*¹, Joe Armstrong²; (1)SePRO Corporation, Southaven, MS, (2)SePRO Corporation, Carmel, IN **(202)**
- 09:30 AM Targeting Dallisgrass and Other Weeds in Warm-Season Turfgrass Systems Using the Ecorobotix ARA** Jay McCurdy*¹, Amy Wilber¹, Shawn Askew², Juan Romero Cubas², Navdeep Godara², Pierre Le Naour Vernet³; (1)Mississippi State University, Starkville, MS, (2)Virginia Tech, Blacksburg, VA, (3)Ecorobotix, Yverdon-les-Bains **(203)**
- 09:45 AM Efficacy of Dodhylex™ Active (tetflupyrolimet) for Annual Bluegrass Control in Virginia Turf** Shawn Askew*¹, Kendall Hutto²; (1)Virginia Tech, Blacksburg, VA, (2)FMC, Newark, NJ **(204)**
- 10:00 AM BREAK**

- 10:15 AM Using Dew Retention Patterns for Bermudagrass (Cynodon dactylon) Detection in Zoysiagrass (Zoysia spp.)** Amy Wilber*¹, Jay McCurdy¹; (1)Mississippi State University, Mississippi State, MS **(205)**
- 10:30 AM Seedling Zoysiagrass Response to Fluazifop-butyl and Trifloxysulfuron-methyl with the Safener Metcamifen** David Nistler*¹, Hannah Wright Smith¹, Michael Richardson², Lane Tredway³, John McCalla⁴; (1)University of Arkansas Division of Agriculture Research & Education, Little Rock, AR, (2)University of Arkansas, Fayetteville, AR, (3)Syngenta Group, Greensboro, NC, (4)University of Arkansas Department of Horticulture, Fayetteville, AR **(206)**
- 10:45 AM Downslope Lateral Movement of Tetflupyrolimet and Pronamide in Turfgrass** Benjamin Pritchard*¹, Travis Gannon², Ronald Rogers², Tyler Carr³, Jim Brosnan¹; (1)University of Tennessee, Knoxville, TN, (2)North Carolina State University, Raleigh, NC, (3)The Ohio State University, Columbus, OH **(207)**
- 11:00 AM Exploring Kelvin Combinations for Broad-spectrum Weed Control in Warm-Season Turf** Suzannah Hale*¹, Navdeep Godara¹, Juan Romero¹, Shawn Askew¹; (1)Virginia Tech, Blacksburg, VA **(208)**
- 11:15 AM END OF SESSION**

WEDNESDAY MORNING JANUARY 22

Physiological and Biological Aspects of Weed Control

LOCATION: Crystal F
TIME: 10:30 AM - 11:30 AM ET
CHAIR: Luis Avila
Mississippi State University
Starkville, MS
MODERATORS: Antonio Tavares and
Sydney Baker
Mississippi State University
Starkville, MS

***SPEAKER**

- 10:30 AM** **Herbicidal mechanism of action of costunolide, a sesquiterpene lactone** Bruna Dal'Pizol Novello*¹, Fernanda Souza², Leticia Leite³, Tamara Heck⁴, Luis Avila², Te Ming Tseng², Pedro Luis da Costa, Aguiar Alves³; (1)São Paulo State University, Mississippi State University, Jaboticabal, (2)Mississippi State University, Starkville, MS, (3)São Paulo State University, Jaboticabal, (4)Federal University of Pelotas, Pelotas **(209)**
- 10:45 AM** **Impact of Blue Light Exposure on Weed Seed Viability** Sarah Chu*¹, Sarah Kezar², Shuyang Zhen¹, Muthukumar Bagavathiannan¹; (1)Texas A&M University, College Station, TX, (2)Cornell University, Ithaca, NY **(210)**
- 11:00 AM** **Confirmation of Glyphosate Resistance in Annual Bluegrass via EPSPS Duplication in a Soybean and Rice Rotation** Susee Sudhakar*¹, Jason Norsworthy¹, Tristen Avent¹, Fidel Gonzalez Torralva², Scott McElroy³, Thomas Butts⁴; (1)University of Arkansas, Fayetteville, AR, (2)Texas A&M University, College Station, TX, (3)Auburn University, Auburn, AL, (4)Purdue University, West Lafayette, IN **(211)**

**11:15 AM Herbicide Response of Tropical Spiderwort
(*Commelina benghalensis*) as Affected by CO₂
and Soil Moisture Levels.** Andrew
Ahlersmeyer*¹, Steve Prior¹, Andrew Price¹,
Aniruddha Maity²; (1)USDA-ARS, Auburn, AL,
(2)Auburn University, Auburn, AL **(212)**

11:30 AM END OF SESSION

WEDNESDAY AFTERNOON JANUARY 22

Weed Management in Agronomic Crops

LOCATION: Crystal C
TIME: 2:30 PM - 4:30 PM ET
CHAIR: Pete Eure
Syngenta Crop Protection
Greensboro, NC

MODERATOR: Jackson Alsford
NC State University
Raleigh, NC

***SPEAKER**

02:30 PM Introducing INTERLINE® MEGA Powered by L-tek™ for Optimized L-glufosinate Applications to Glufosinate-tolerant Row and Specialty Crops Ryan Bryant-Schlobohm*¹, Cody Gray², Ryan Henry³, Carlos Antonio Koury d'Arce Junior⁴; (1)UPL NA, Inc, Amarillo, TX, (2)UPL NA, Inc, Peyton, CO, (3)UPL NA, Inc, Fort Wayne, IN, (4)UPL NA, Inc., Cary, NC **(213)**

02:45 PM Effect of Multiple Very-Long-Chain Fatty Acid-Inhibiting Herbicide Applications on Soybean Yield Wesley Everman*¹, Diego Contreras², Eric Jones³, Dave Vos³, Jill Alms³; (1)Iowa State University, Ames, IA, (2)North Carolina State University, Raleigh, NC, (3)South Dakota State University, Brookings, SD **(214)**

03:00 PM Preemergence Herbicide Programs For Mississippi Soybean Gregory Mangialardi*¹, Jason Bond¹, Lindsey Bell¹, Dalton Whitt¹, Thomas Eubank¹, Matt Edwards¹, Jacob Dodd¹; (1)Mississippi State University, Starkville, MS **(215)**

- 03:15 PM Evaluation of Axant™ Flex cotton systems utilizing topramezone** Maxwell Smith*¹, Todd Baughman², Jennifer Dudak³, Brad Guice⁴; (1)Oklahoma State University, Altus, OK, (2)Texas A&M AgriLife Research, Lubbock, TX, (3)Oklahoma State University, Stillwater, OK, (4)BASF, Winnsboro, LA **(216)**
- 03:30 PM Is Glufosinate Resistance in Palmer amaranth Spreading in Mississippi County, Arkansas?** Pamela Carvalho-Moore*¹, Jason Norsworthy¹, Aimone Porri², Caio dos Santos³, Tom Barber⁴, Susee Sudhakar¹, Ingo Meiners⁵, Jens Lerchl²; (1)University of Arkansas System Division of Agriculture, Fayetteville, AR, (2)BASF SE, Ludwigshafen, (3)Iowa State University, Ames, IA, (4)University of Arkansas System Division of Agriculture, Lonoke, AR, (5)BASF, Research Triangle Park, NC **(217)**
- 03:45 PM Development of Convintro™ Brand Herbicides for Managing Amaranthus Species in Corn and Soybean: Field Performance Update.** Jody Gander*¹, Katilyn Price¹, Carl Coburn¹, Richard Leitz¹, Zewei Miao¹, Emily Scholting¹; (1)Bayer Crop Science, St. Louis, MO **(218)**
- 04:00 PM Evolution of HPPD-Resistance added to Palmer amaranth Resistant to Group 2, 4, 9 and 14 in Tennessee** Lawrence Steckel*¹; (1)University of Tennessee, Jackson, TN **(219)**
- 04:15 PM Are Chemistry and Traits Staying Ahead of Palmer Amaranth?** Jason Norsworthy*¹, Lon Barber¹, Bob Scott¹, Lawrence Steckel²; (1)University of Arkansas System Division of Agriculture, Lonoke, AR, (2)University of Tennessee, Jackson, TN **(220)**
- 04:30 PM END OF SESSION**

WEDNESDAY AFTERNOON JANUARY 22

Weed Management in Horticultural Crops

LOCATION: Crystal D
TIME: 2:30 PM - 3:30 PM ET
CHAIR: Greg Steele
Bayer Crop Science
Hillsboro, TX

MODERATOR: Greg Steele
Bayer Crop Science
Hillsboro, TX

***SPEAKER**

02:30 PM Identification of Weed Species that Act as Reservoirs for Confirmed and Emerging Vegetable Viruses. Matthew Cutulle*¹, Harrison Campbell¹, Kai Ling²; (1)Clemson University, Clemson, SC, (2)USDA ARS USVL, Charleston, SC **(221)**

02:45 PM Field Study on the Effect of Soil Steaming Durations on Yellow Nutsedge Tuber Germination at Different Soil Depths John Mathis Arnold*¹, Te Ming Tseng¹, Alaina Richardson¹; (1)Mississippi State University, Starkville, MS **(222)**

03:00 PM Sweetpotato Varietal Response to Pre- and Post-Planting Herbicides Prakriti Dhaka*¹, Juan C. Velasquez¹, Giovana de Carvalho Silva¹, Te Ming Tseng², Nilda Roma-Burgos¹; (1)University of Arkansas, Fayetteville, AR, (2)Mississippi State University, Mississippi State, MS **(223)**

03:15 PM Bambara Nut (*Vigna subterranea*) Response to PRE and POST Herbicides in Greenhouse and Field Studies Samuel Crawford*¹, Lucas Lieber¹, Devon Carroll¹, Dennis Muc¹, Jonathan Schultheis¹, Levi Moore¹, Zachary Small¹; (1)North Carolina State University, Raleigh, NC **(224)**

03:30 PM END OF SESSION

AUTHOR INDEX

Ahlawat, Himani	135, 137, 145, 164,180
Ahlersmeyer, Andrew	32, 212
Akanbi, Tunde	66,148
Almashwali, Ayman	67, 133
Alsdorf, Jackson	54, 104, 111, 126, 128, 149,151
Anokye, Bismark	3, 60, 170
Argenta, Josiane	71, 106, 140
Argueta, Ronel	54, 104, 111, 126, 128, 149, 151
Arnold, John Mathis	133, 222
Askew, Shawn	24, 35, 73, 110, 146, 168, 203, 204, 208
Avent, Tristen	4, 17, 18, 80, 139, 150, 161, 171, 196, 197, 211
Baker Holley, Sydney	1, 124
Bangarwa, Sanjeev	94, 188
Bararpour, Taghi	34, 36, 43, 49, 63
Basinger, Nicholas	46, 107, 135, 137, 145,158, 164,180
Baxley, Rhet	18, 51, 75
Bazzle, Joseph	131
Begitschke, Eick	10, 29
Bell, Lindsey	69, 116, 119, 123, 215
Beneton, Karina	121
Black, B. David	190
Bortolon, Guilia	20, 26, 83, 85, 86, 127
Bowen, Samantha	91, 96, 157, 158, 179
Bradshaw, Colden	54, 104, 111,125, 126, 128, 149,151
Brar, Akashdeep	61, 162, 172
Briscoe, Kyle	202
Broster, Kayla	7, 143, 165, 181, 183
Bryant-Schlobohm, Ryan	213
Byrd, John	7, 101, 143, 165, 181, 183
Camargo Silva, Gustavo	95, 166
Campbell, Tyler	70
Campos, Priscila	135, 137, 164
Carr, Wesley	14, 33, 37, 58,59, 115, 117,122,163
Carvalho-Moore, Pamela	39, 74, 75, 80, 161, 217
Chahal, Gourav	28, 192
Chase, Carlene	186
Chattha, Sohaib	44, 134
Chu, Sarah	5, 79, 167, 210
Clabo, David	175, 176
Contreras, Diego	54, 104, 111, 126, 128, 139, 149, 151, 171, 214

Cordero, Nestor	49, 72, 124
Crawford, Samuel	89, 92, 224
Cutulle, Matthew	12, 40, 44, 70, 97, 131, 132, 134, 136, 221
Dal' Pizol Novello, Bruna	8, 133, 209
Davis, Forrest	66, 148, 185
de Sanctis, Jose	41, 112
de Souza Rodrigues, Juliana	46, 96, 107
Dean, Brock	41, 112, 120, 125
Dhaka, Bhupesh	20, 26, 83, 85, 86, 127
Dhaka, Prakriti	15, 90, 156, 198, 223
Dodd, Jacob	114, 119, 123
Dodde, Michael	4, 17, 18, 51, 75, 139, 196, 197
Duncan, Thomas	7, 143, 165, 181
Smith III, Charles	135, 137, 145, 158, 180
Eason, Kayla	91, 157, 158, 179,
Esmacilbeiki, Fatemeh	2, 172
Eubank, Thomas	69, 114, 116, 119, 123, 215
Everman, Wesley	54, 104, 111, 126, 128, 139, 149, 151, 171, 214
Foote, Ethan	93, 160
Fuller, Colton	130
Furlan Jr, Roger	147
Gander, Jody	218
Gawron, Katarzyna	9, 23, 52
Ghosh, Rakesh	65, 177
Goble, Kai	89
Godar, Amar	82, 184
Godara, Navdeep	24, 35, 73, 146, 168, 203, 208
Goldsmith, Avi	77, 152
Gregory, Chris	7, 143, 165, 181, 183
Grey, Timothy	46, 96, 107, 158, 179
Gupta, Priyanka	40
Gyawali, Purushottam	13, 105, 195
Hains, Maranda	14, 33,37, 58,59, 115, 117, 122, 163
Hale, Suzannah	24, 35, 110, 208
Hamberg, Ryan	11, 167
Heck, Tamara	48, 154, 209
Herrman, Wesley	80, 161
Holloway, James	31
Howard, Zachary	108, 182
Jakhar, Aman	24
Jha, Prashant	20, 26, 83, 85, 86, 127
Joseph, Mikerly Mistral	9

Ketchum, Cory	18, 51, 150
King, Tanner	114, 116
Kreinberg, Samuel	141
Kumar, Krishna	169
Larini, William Felipe	109
Lazaro, Lauren	4, 100, 104, 126, 128, 171, 197
Lee, Hunter	22, 41, 112, 120
Lindell, Hannah	158, 164, 180
Love, Hayden	6
Malone, James	16, 200
Mangialardi, Gregory	69, 114, 116, 119, 123, 215
Marshall, Michael	39, 88, 136
McCullough, Patrick	56, 57
McCurdy, Jay	24, 142, 144, 201, 203, 205
McEachin, Annabelle	107
Mckoin, Connor	20, 26, 85, 86, 127
Miller, Donnie	26, 83, 85, 86, 127
Miller, Alyssa	71, 133, 140
Minaev, Nikolay	144
Monsalud, Keith Andrej	15, 198
Mueller, Thomas	147, 178, 189
Nistler, David	87, 206
Nolte, Scott	103, 108, 182, 199
Norsworthy, Jason	4, 13, 16, 17, 18, 39, 51, 74, 75, 80, 82, 83, 105, 139, 150, 153, 161, 171, 184, 196, 197, 200, 211, 217, 220
Novello, Alberto	53
Ouedraogo, Wilfried	194
Palmer, Eric	31
Pendleton, Brittany	104, 126, 128
Petelewicz, Pawel	9, 23, 52
Phillips, Will	189
Pierce, Lane	4, 17, 139, 150, 196, 197
Pilania, Kamana	135, 137
Pritchard, Benjamin	207
Prostko, Eric	30, 78
Rady, Mahmoud	12
Randell-Singleton, Taylor	19, 42
Reolon de Souza, Fernanda	62
Richardson, Alaina	68, 71, 133, 140, 222
Rodriguez, Diego	15, 98, 155, 156, 198
Romero, Juan	24, 35, 168, 203, 208
Ross, Aidan D.	153
Russell, Eli	5, 81, 191
Russell, Kyle	174

Shay, Nicholas	30, 78
Silva Martins, Pedro A.	96
Simon, Warner	113
Singh, Akashdeep	25, 61, 162, 172, 173, 193
Singh, Simardeep	97, 132
Singh, Gursewak	136
Singh, Vijay	2, 21, 61, 162, 172, 173
Singletary, Megan	38, 102, 118, 138
Smith, Logan	45
Smith, Maxwell	199, 216
Smitherman, Debra	66, 99, 129
Souza, Fernanda	62, 84, 209
Sparks, Gavin	14, 33, 37, 58, 59, 115, 117, 122, 163
Steckel, Lawrence	39, 139, 147, 159, 171, 178, 189, 219, 220
Stoker, Ben	14, 37, 58, 59, 115, 117, 122, 163
Stutzman, Wyatt	171
Sudhakar, Susee	39, 153, 211, 217
Szoch, Luke	50
Tavares, Antonio Augusto	1, 124
Vance, Jenna	19
Varanasi, Vijay	63
Velasquez, Juan	15, 55, 98, 155, 156, 198, 223
Viric, Milos	27, 172
Wamanse, Rutvij	21, 172, 173
Wang, Chih Julie	10, 29, 142
Ward, Christina	199
Ward, James	159
Warris, Aliyah	76, 187
Wayhs Backes, Caroline	103
Whitt, Dalton	69, 114, 116, 119, 123, 215
Wilber, Amy	24, 201, 203, 205
Williams, Eve	14, 37, 58, 59, 115, 117, 122
Wong, Walter	47, 64
Woolard, Matthew	38, 102, 118, 138
Young, Audrey	29, 142

SWSS Sustaining Members	2024-2025
Platinum (\$10,000 +):	Bayer CropScience Syngenta Crop Protection
Gold (\$5,000-\$9,999):	BASF Corporation Corteva Agriscience FMC
Silver (\$2000-\$4,999)	BASF Trait Development Blue River Tech Cotton Inc. Gylling Data Management Nutrien
Bronze (\$200-\$1,999)	ADAMA Agricenter International Bellspray Inc. Diligence Technologies, Inc. Envu Frontier Precision Gowan Helena Agri-Enterprises K.I. Chemical U.S.A. Inc. Nichino Nufarm SePro The Scotts Company United Phosphorus, Inc. Valent USA Corp.

		Personal Time Schedule		
Time		Monday	Tuesday	Wednesday
8:00 AM				
8:15 AM				
8:30 AM				
8:45 AM				
9:00 AM				
9:15 AM				
9:30 AM				
9:45 AM				
10:00 AM				
10:15 AM				
10:30 AM				
10:45 AM				
11:00 AM				
11:15 AM				
11:30 AM				
11:45 AM				
12:00 PM				
12:15 PM				
12:30 PM			Grad Student Luncheon- Emerald Salon One	SWSS Awards Luncheon - Emerald Salon Two and Three
12:45 PM				
1:00 PM	General Session- Crystal C&D			
1:15 PM				
1:30 PM				
1:45 PM				
2:00 PM				
2:15 PM				
2:30 PM				
2:45 PM				
3:00 PM			Women in Weed Science Networking Event- Crystal E	
3:15 PM				
3:30 PM				
3:45 PM				
4:00 PM				
4:30 PM				
5:00 PM				
5:30 PM				
6:00 PM			Quiz Bowl - Emerald Ballroom	Graduate Student Awards Reception - Emerald Ballroom
6:15 PM				
6:30 PM				
6:45 PM				
7:00 PM				
7:15 PM				
7:30 PM				
7:45 PM				
8:00 PM				
8:15 PM				
8:30 PM				
8:45 PM				
9:00 PM				
6:30PM				
7:00PM				
8:00PM				